



Product Guide

A complete guide to building services products





HEATING, **VENTILATION**, PLENUM BOXES, **CHILLED BEAMS**, OVAL, SPIRAL & RECTANGULAR DUCTWORK, **COLD ROOMS**, AIR CONDITIONING UNITS, **MECHANICAL**, PIPEWORK, **CABLE LADDER BASKET & TRAY**, STRIP LIGHTING, **LUMINAIRE**, TRUNKING, BUSBAR, CATENARIES, **SHOPFITTING**, SIGNAGE, **ACOUSTIC BAFFLES**, **SUSPENDED CEILINGS**, BRACING.

Contents

About

About Gripple page 4

Applications

Pipework page 8

HVAC page 10

Electrical page 12

Lighting page 14

Signage page 16

Acoustics page 18

Black Line page 20

Fast Trak page 22

Products

HF Express page 26

HF Classic page 27

Angel page 28

HF Classic Inox page 30

Fast Trak page 32

UniGrip page 34

Trapeze TPZPL page 36

Trapeze TPZGR page 37

Trapeze Plus RF page 38

Y-Fit & Y-Fit Accessory page 40

CTI Kit (Indoor) page 42

EP Kit (Outdoor) page 44

PB Kit page 46

LPB Kit page 47

PFT Kit page 48

CRUFLEX page 50

CRUPHEN page 51

Universal Clamp - Pipework page 52

Universal Clamp - Waste water page 53

Universal Clamp - Ductwork page 54

End fixings

Loop page 58

Stud page 58

Toggle page 59

Cladding Hook page 59

Mini Hook page 60

Hook page 60

Twist Clip (white) page 61

Top Hat page 61

Magnetic Pad page 62

Eyelet page 62

45° Eyelet page 63

90° Eyelet page 63

C-Clip page 64

Barrel page 64

Shot Fire (Powder) page 65

Shot Fire (Gas) page 65

Channel nut page 66

End Stop page 66

QT Barrel page 67

Cable Tray Hook page 67

Accessories

Anchoring Solutions page 70

Beams & Purlins page 72

Brackets & Attachments page 73

Adaptors page 74

Other Accessories page 75

Accessories page 76

Tools & Finishing Accessories page 77

Technical

Technical Services page 80

Hanging at Angles page 84

Wire Rope Construction page 84

Nominal Ductwork Weights page 85

Pipe Support Spacing page 86

Key Recommendations page 87

About Gripple

Of the 640 strong Gripple team working worldwide, more than 130 people are dedicated to servicing Europe. All are experts in suspension solutions for HVAC, M&E, modules, lighting, acoustics and signage. Our facilities in Europe enable us to offer a flexible, reactive service to find a solution to your problem, and deliver it quickly.



“...the company's capabilities are now recognised, admired and trusted worldwide.”

From contractors to consultants, we offer:

- Suspension System Installation Design Service – we'll advise on what you need and where
- Expertise, product take-off from plan
- Technical load and structural calculations
- BIM solutions
- CAD drawings
- Environmental Impact Studies
- On-site visits to assess installations and discuss potential solutions
- Product training – for specific installations or for the latest new products
- Regular on-site advice until job completion



What we do

Time Savings

Save up to 85% on installation times when you choose to use one of Gripple's wire rope kits, when compared to traditional methods. Not only is the installation faster, no pre-work, such as cutting or filing is required.

Health & Safety

Gripple wire rope kits are ready-to-use straight from the box, removing the need for potentially hazardous hot works and cutting on site. One box of HF Express No.2 kits weighs just 8 kg, doing the same job as 150 kg of threaded rod and channel. Not only is the weight and bulk of carry material reduced, but also the time spent working at height.

CO₂ Savings

For every metre of Gripple wire rope specified to replace threaded rod, it is estimated that a saving of 1,2 kg of embodied CO₂ is made. This equates to a total embodied CO₂ saving of up to 95% when switching from threaded rod to Gripple wire rope.

Aesthetics

Gripple wire rope kits are lightweight and virtually invisible. Comparing 2 mm wire rope to 8 mm threaded rod, the difference is easy to see. With a trend towards exposed services, Gripple wire rope kits enhance the workspace significantly – especially in retail environments. We also offer a range of black wire rope kits ideal for cinemas, theatres and other areas where the ceiling is painted black (See page 20).



"...83% OF FABRICATION
WORK TOOK PLACE OFF-SITE;
GRIPPLE SOLUTIONS
CONTRIBUTED TO REDUCING
DELIVERY SCHEDULE
BY **SIX MONTHS...**"

LEADENHALL BUILDING, LONDON



Applications

Pipework page 8

HVAC page 10

Electrical page 12

Lighting page 14

Signage page 16

Acoustics page 18

Black Line page 20

Fast Trak page 22

Pipework



Universal clamp -
Waste Water

Page 53



Universal Bracket
Beam Clamp

Page 75

PB Kit

Page 46



CRUPHEN

Page 51



The Gripple® range of supports and hangers has been developed to provide a fast and versatile solution for suspending all types of pipework.

Gripple products are designed to save time, labour and reduce costs by making the installation quicker and easier. Supplied in ready-to-use kits, the products in this range require no on-site cutting and eliminate the need for fabricating pipe bracket assemblies, offering enormous health and safety benefits for your project.



LPB Kit
Page 47



Wall Bracket
Page 75



UniGrip – QT
Page 34



CRUFLEX
Page 50



Products shown are for internal use only. Images shown for illustrative purposes only.
Please refer to product installation instructions for full information.

HVAC

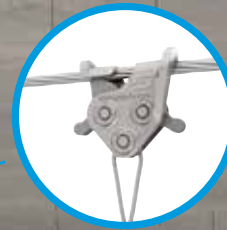

C-Clip
Page 64



CTI Kit
Page 42



UniGrip – Y-Fit
Page 34

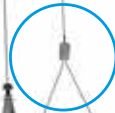

HF Express
Page 26

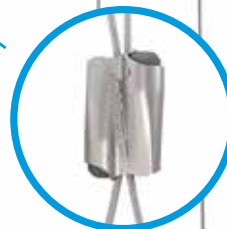

UniGrip – Central Exit
Page 34

Products shown only for internal use. Images shown for illustrative purposes only.
Please refer to product installation instructions for full information.



Trapeze TPZPL

Page 36

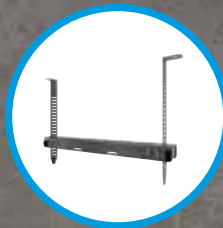

Fast Trak

Page 32



Trapeze TPZGR

Page 37

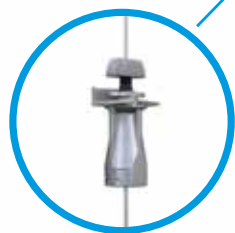

UniGrip – Standard

Page 34



UniGrip – Calibra

Page 34

The Gripple® range of hangers for HVAC applications has been developed to provide a fast and versatile solution for suspending ductwork, heaters, air conditioning, radiant panels and plenum boxes.

Our products are manufactured in the UK, and are designed to save you time, and labour costs, thus improving the efficiency of your installation. Unlike traditional methods, Gripple kits do not require cutting, filing or “hot works” permits. Gripple suspension solutions offer aesthetic design without compromising on strength; supplied in kits ready for use with a choice of wire rope lengths and end fixings.

Electrical

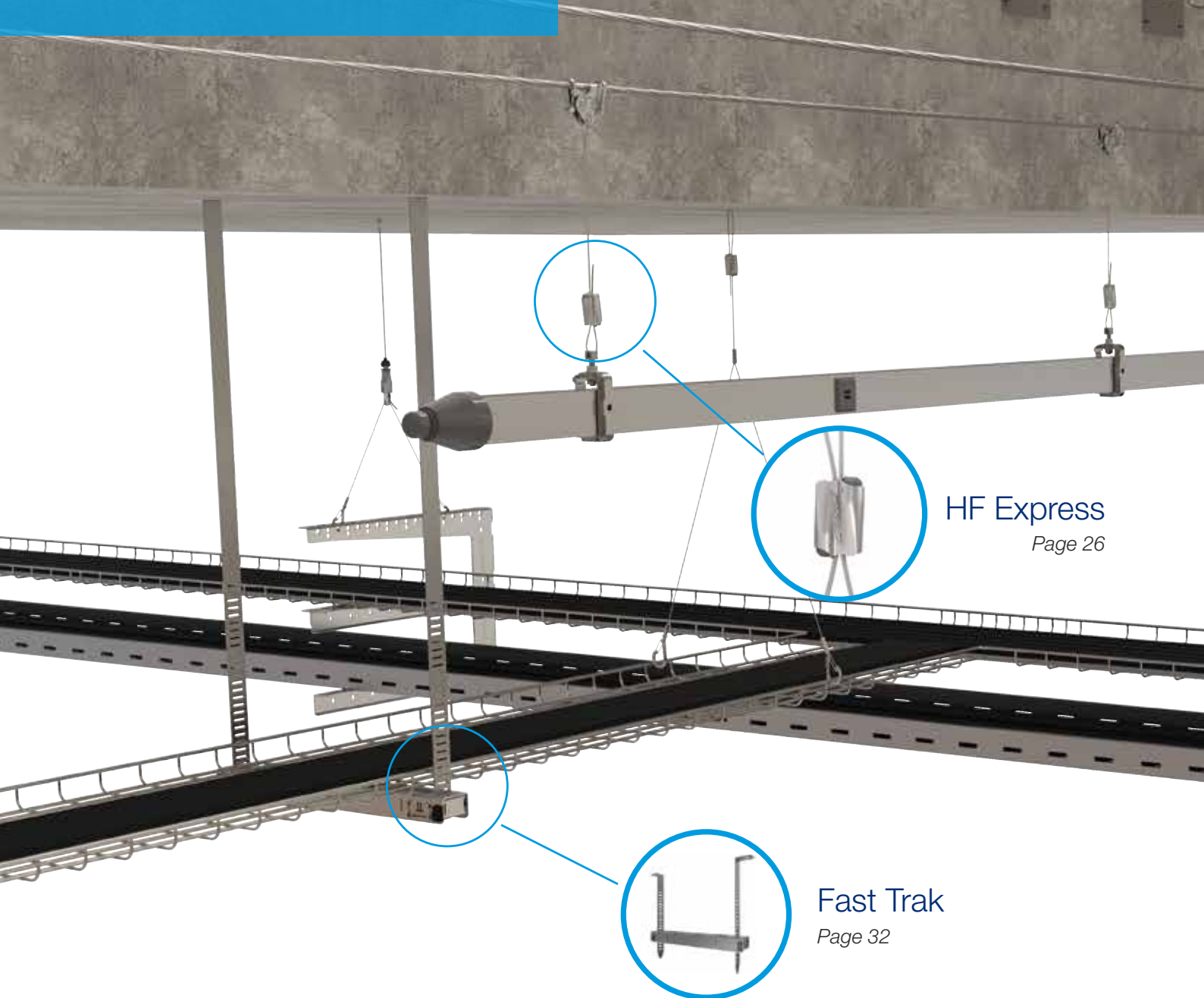

HF Express
Page 26

Fast Trak
Page 32

The Gripple® range of supports and hangers for electrical applications has been developed to provide a fast and versatile solution for suspending all types of electrical containment.

Gripple products are designed to save time, labour and reduce costs by making the installation quicker and easier. Supplied in ready-to-use kits, the products in this range are lightweight, require no on-site cutting and reduce the time spent at height, offering enormous health and safety benefits for your project.

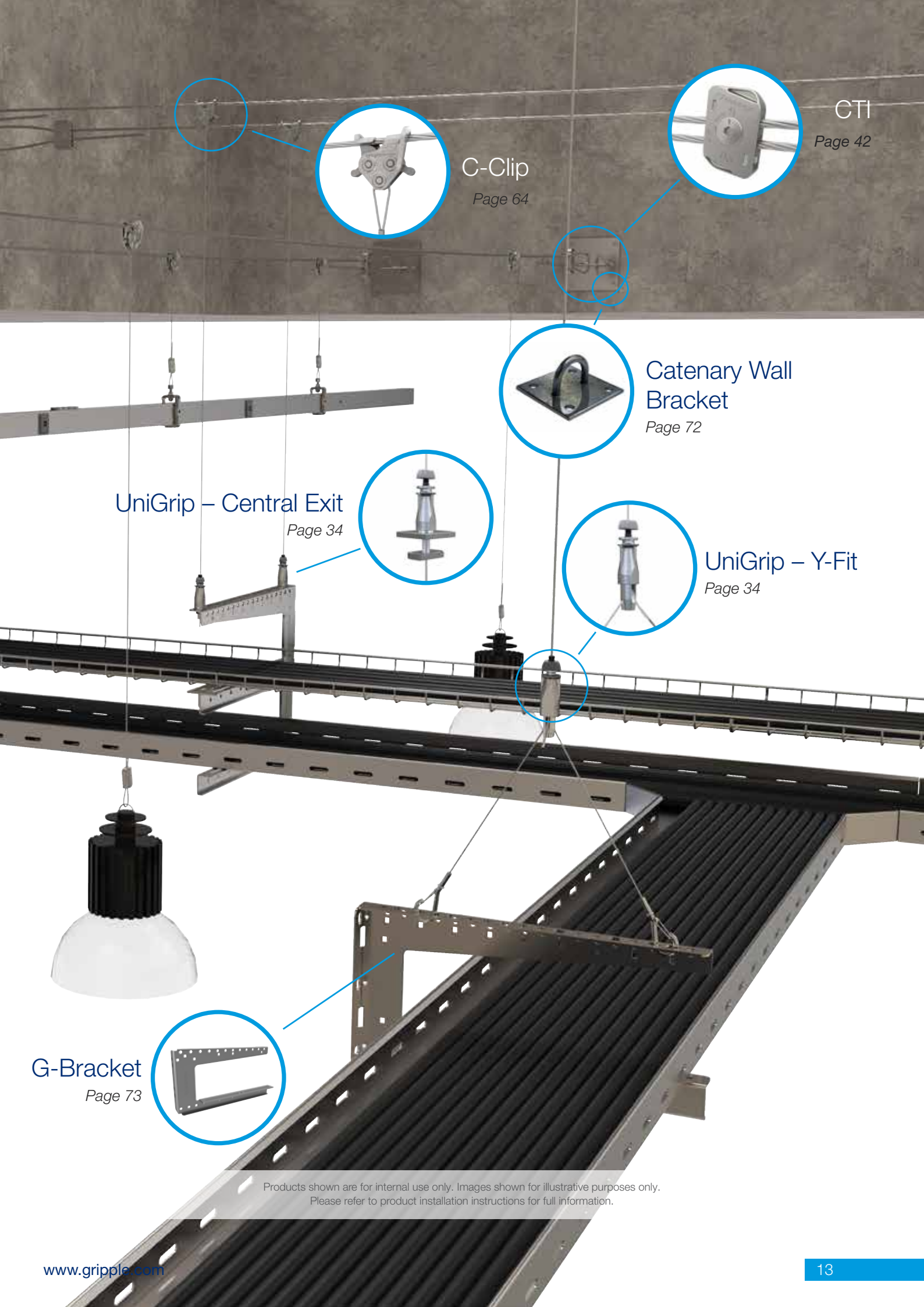

CTI
Page 42

C-Clip
Page 64

Catenary Wall
Bracket
Page 72

UniGrip – Central Exit
Page 34

UniGrip – Y-Fit
Page 34

G-Bracket
Page 73

Products shown are for internal use only. Images shown for illustrative purposes only.
Please refer to product installation instructions for full information.

Lighting

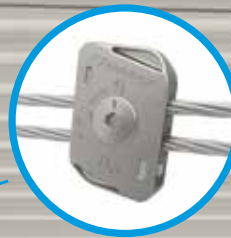

CTI Kit

Page 42



GF Bracket

Page 72

HF Express

Page 26

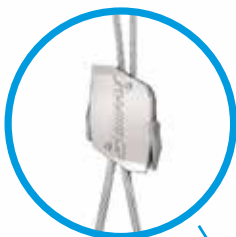

The Gripple® range of suspension solutions for lighting are manufactured in the United Kingdom, and have been designed to save you time, money and labour by improving the efficiency of the installation process. Unlike traditional methods, Gripple kits require no on-site cutting, filing or hot works, so offer enormous health and safety benefits for your project.

Our products offer a sleek, professional and discreet finish, without compromising on strength; supplied in ready-to-use kits with your choice of end fixing and wire rope length.

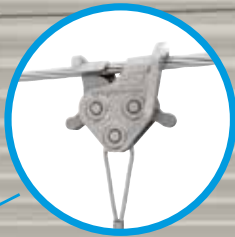
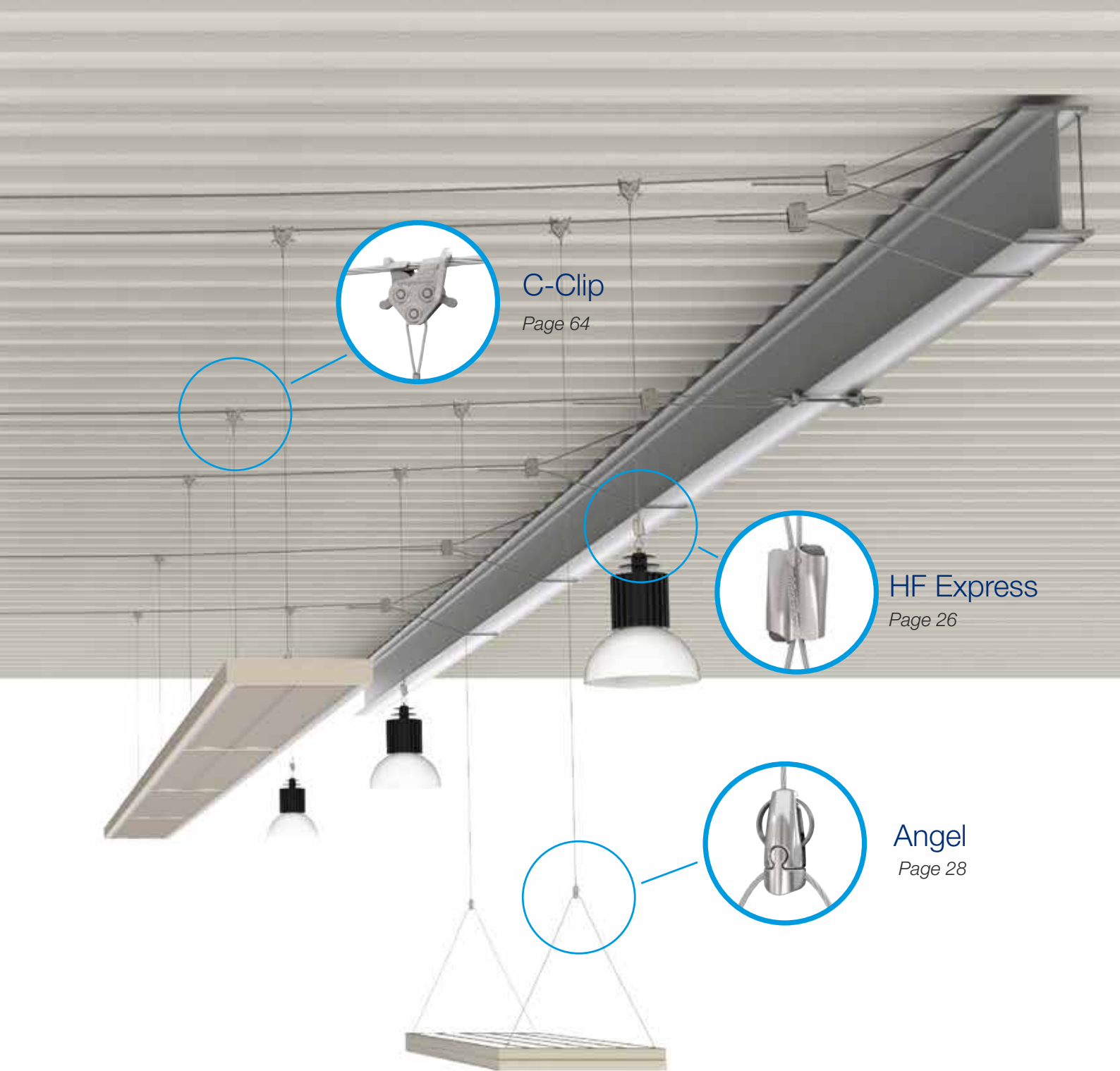

C-Clip
Page 64

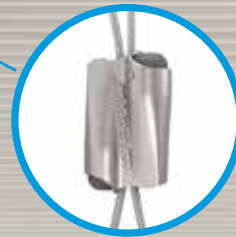

HF Express
Page 26

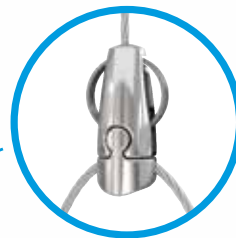

Angel
Page 28

Angel has a wide range of feet available to suit your lighting application.
See page 29 for details.



Products shown only for internal use. Images shown for illustrative purposes only.
Please refer to product installation instructions for full information.

Signage

Angel Signage

Page 29

Angel has a wide range of feet available to suit your signage application.

See page 29 for details.



The Gripple® range of signage products has been developed to provide a complete solution for the suspension of all forms of signage.

The variety of kits allows for complete flexibility and adjustability, without the use of additional tools. The range of designs provides a sleek, professional finish for you and your clients, without compromising on strength.

Our kits have been designed to save you time, labour and money by making installation quick and easy.

Angel Swivel

Page 29



Angel Hook

Page 29



Angel Signage Rail

Page 29



Products shown only for internal use. Images shown for illustrative purposes only.
Please refer to product installation instructions for full information.

Acoustics

Angel Hook

Page 28



The Gripple® range of acoustic solutions are manufactured in the United Kingdom, and have been designed to save you time, money and labour by improving the efficiency of the installation process. Unlike traditional methods, Gripple kits require no on-site cutting, filing or use of uPVC frames, so offer enormous time-saving benefits for your project.

Gripple products can fit directly into acoustic baffles and panels, uPVC frames and suspended ceilings, offering a sleek, professional and discreet finish, without compromising on strength. All products are supplied in ready-to-use kits with your choice of end fixing and wire rope length.

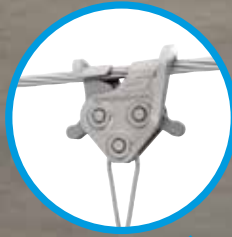

CTI Kit
& C-Clip
Page 42 & 64



Angel Side Exit -
Male
Page 28



Acoustic Spring
Anchor
Page 75

Products shown only for internal use. Images shown for illustrative purposes only.
Please refer to product installation instructions for full information.

Black Line

Catenary Kit

Page 42



C-Clip

Page 64



Trapeze TPZPL

Page 36

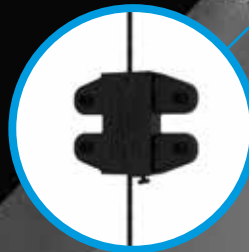

Gripple's ready-to-use suspension kits now come with the option of a black finish to further enhance the aesthetic appeal of the range.

The slim and unobtrusive aesthetics of Gripple's wire suspension systems have always proved perfectly suited to the design of many modern buildings, either where building services in the roof space are left exposed and visible, or for specific applications such as the suspension of lighting.

The new black line of products aims to build on this success and will be ideal for use in a wide variety of environments where aesthetics are paramount, including retail spaces, theatres, exhibition and concert halls.



Trapeze TPZGR
Page 37



HF Express
Page 26



UniGrip – Central Exit
Page 34

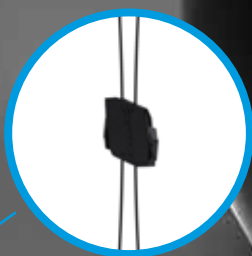

HF Express
Page 26

Products shown only for internal use. Images shown for illustrative purposes only.
Please refer to product installation instructions for full information.

Fast Trak

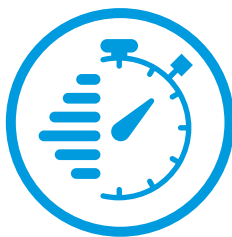

QUICK

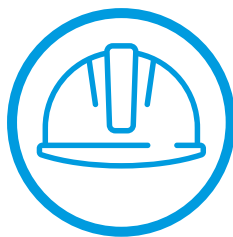

SAFE

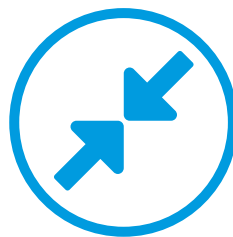

SPACE SAVER



TOOL FREE

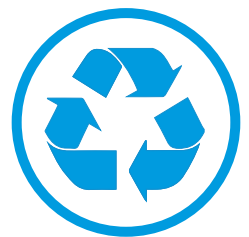

ZERO WASTE



See Fast Trak product information on page 32

For further product information please call +33 (0)3 88 95 44 95 or visit our website www.gripple.com



Products

HF Express	page 26
HF Classic	page 27
Angel	page 28
HF Classic Inox	page 30
Fast Trak	page 32
UniGrip	page 34
Trapeze TPZPL	page 36
Trapeze TPZGR	page 37
Trapeze Plus RF	page 38
Y-Fit & Y-Fit Accessory	page 40
CTI Kit (Indoor)	page 42
EP Kit (Outdoor)	page 44
PB Kit	page 46
LPB Kit	page 47
PFT Kit	page 48
CRUFLEX	page 50
CRUPHEN	page 51
Universal Clamp - Pipework	page 52
Universal Clamp - Waste water	page 53
Universal Clamp - Ductwork	page 54

HF Express

Solution for fast suspension of a variety of services, designed with a keyless release mechanism.

- The HF Express No.1 is ideal for signage, shopfitting, lighting and other lightweight fixtures
- The HF Express No.2 is ideal for mechanical and electrical applications
- Up to 6 times faster to install than traditional methods
- Keyless - no tool required for adjustment
- Ergonomic buttons allow rapid adjustment
- Discreet and aesthetic design



Available in sizes No.1 - No.2



All hangers are supplied as ready-to-use kits with a length of wire rope and end fixing of your choice.

5:1 SAFETY FACTOR LOAD RATING	No.1	No.2
	15 kg	45 kg

END FIXINGS
PAGE 57

ACCESSORIES
PAGE 69

TECHNICAL
PAGE 79

PART CODES
PAGE 31

Installation

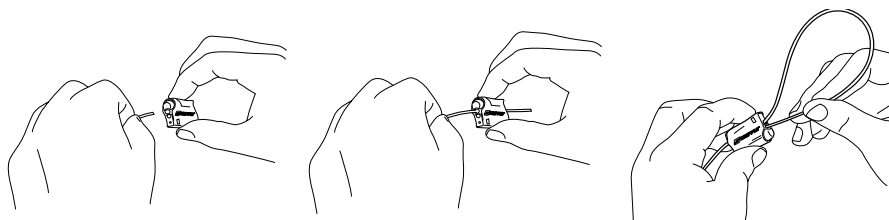

Release



HF Classic

Used to suspend a variety of HVAC, pipework and electrical services from different substrates, complete with end fixings.

- Ideal for fast suspension of heavy cable containment, pipework, radiant panels
- Up to 6 times faster to install than traditional hanging systems
- Versatile and simple to use
- Strong, safe and industry approved
- Aesthetically discreet and lightweight



Available in sizes No.3 - No.4 - No.5

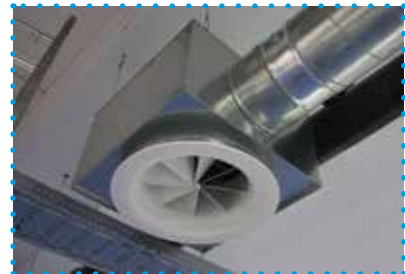

All hangers are supplied as ready-to-use kits with a length of wire rope and end fixing of your choice.

5:1 SAFETY FACTOR LOAD RATING	No.3	No.4	No.5
	90 kg	225 kg	325 kg

END FIXINGS
PAGE 57

ACCESSORIES
PAGE 69

TECHNICAL
PAGE 79

PART CODES
PAGE 31

Installation

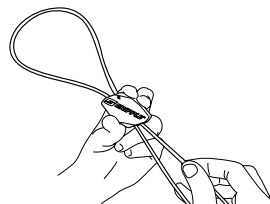
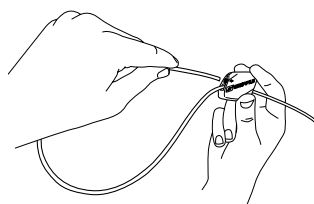
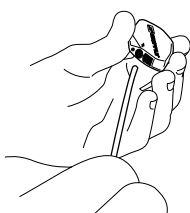

Release

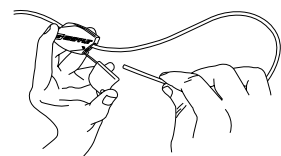

Angel

Designed for architectural lighting suspensions, signage, acoustic baffles and installations where aesthetics are important.

- Simple one handed operation for easy adjustment
- Contemporary design to complement the overall suspension
- Extensive range of end fixings allowing installation in most locations
- Variety of feet fixings to enable attachment to different fixing points
- Uses 1,5 mm wire rope to make the suspension as discreet as possible



 **BLACK LINE**



Available with a range of feet fixings



All hangers are supplied as ready-to-use kits with a length of wire rope and end fixing of your choice.

5:1 SAFETY FACTOR LOAD RATING	No.1
	15 kg

END FIXINGS PAGE 57	ACCESSORIES PAGE 69	TECHNICAL PAGE 79	PART CODES PAGE 31
------------------------	------------------------	----------------------	-----------------------

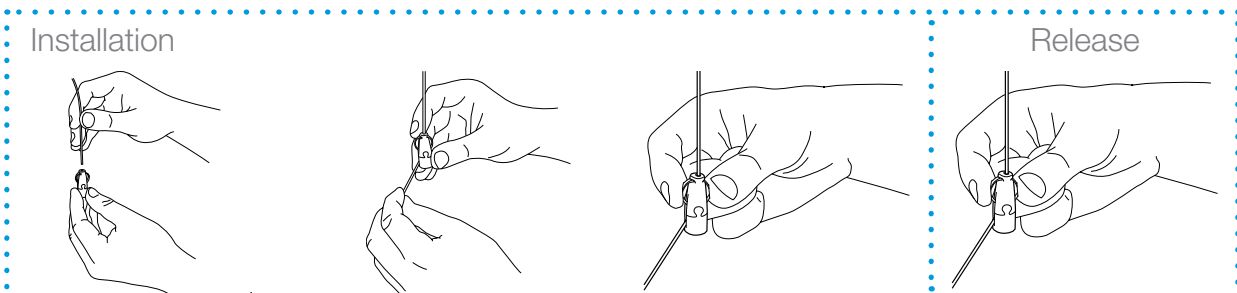

Angel Feet

The Angel is now even more versatile with a wide range of feet available to suit your application.

Central Exit

- Threaded male foot, ideal for direct attachment to light fittings
- Available in M6
- 5 mm minimum exposed thread length as standard
- Central wire exit



Side Exit Male

- Threaded male foot, ideal for direct attachment to light fittings, frames and acoustic panels
- Available in M4, M6 as standard M5, M8, M10 and M13 adaptors available
- 12 mm exposed thread length as standard



Y-Fit

- Dual fixing points for balance
- 150 and 300 leg lengths



Side Exit Female

- Female threaded foot, ideal for direct attachment to light fittings, frames and acoustic panels
- Available in M4, M6
- Maximum insertion depth 6 mm



Disc

- Ideal for use with various lighting tracks and track hangers
- Disc diameter Ø 17,5 mm
- Side wire exit



Swivel

- Swivel feature for suspension at angles up to 90°
- Available in M4, M6, M8
- Female: maximum insertion depth 6 mm
- Male: 12 mm exposed thread length as standard
- Side wire exit



Hook

- Ideal for light fittings, signage, or for use with eyebolts, spring and wire anchors
- Safety clasp for security
- Integrated hook with 5 mm clearance
- Side wire exit



Signage

- Ideal for signage up to 5 mm in thickness
- Grub screw for direct attachment
- Side wire exit



T

- Ideal for suspending signage or panels on either a rail or by screws
- Two screw holes for direct attachment
- Central wire exit



All hangers are supplied as ready-to-use kits with a length of wire rope and end fixing of your choice.

END FIXINGS - PAGE 57

ACCESSORIES - PAGE 69

TECHNICAL - PAGE 79

HF Classic Inox

Used to suspend a variety of mechanical and electrical services in the food industry and high humidity environments.

- Stainless steel body and springs are corrosion resistant and long-lasting
- Ceramic wedges for extra strength and corrosion resistance
- Aesthetically discreet and lightweight
- Available in two sizes load rated up to 90 kg SWL
- Supplied as a ready-to-use-kit
- Available for use with Loop, M8 Stud, End Stop, Karabiner and Toggle end fixings



Available in sizes No.2 - No.3



All hangers are supplied as ready-to-use kits with a length of wire rope and end fixing of your choice.

5:1 SAFETY FACTOR LOAD RATING	No.2	No.3
	45 kg	90 kg

END FIXINGS
PAGE 57

ACCESSORIES
PAGE 69

TECHNICAL
PAGE 79

PART CODES
PAGE 31

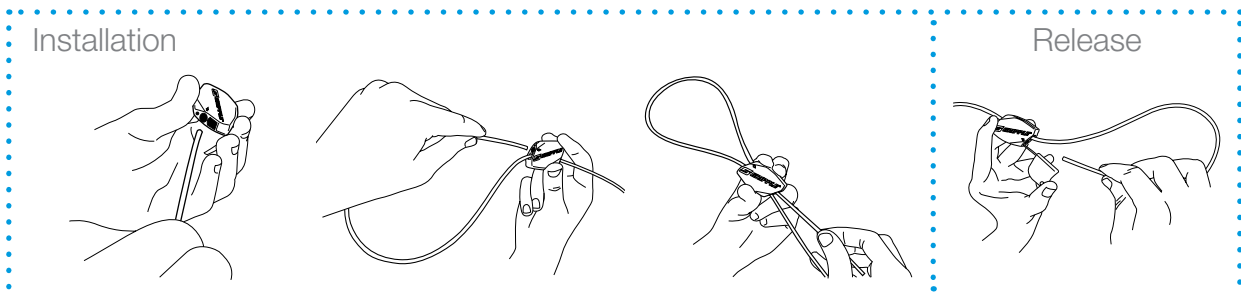

How to work out your unique product code

CHOOSE YOUR PRODUCT



(eg. ALSM41 = Ø4)

* HF4 is available with Loop and M10 Stud end fixing only. HF5 is available with Loop end fixing only.

CHOOSE YOUR WIRE LENGTH (in meter)

10

CHOOSE YOUR END FIXING



* Only available for HF Express No.1 and Angel hanger. ** Only available with No.1 and No.2.

Enter your unique product code (e.g. **XP210FR**):

END FIXING

For more available End Fixings and further product information please call +33 (0)3 88 95 44 95 or visit our website www.gripple.com for further details.

Fast Trak™

Pre-fabricated, trapeze bracket solution offering speed, flexibility and efficient use of space, for the installation of electrical containment, pipework, ductwork and other mechanical services in restricted places.

- Quick - up to six times faster to install than traditional suspension systems
- Safe - pre-fabricated system which removes the need to cut threaded rod or channel on site
- Tool free - bracket can be moved up and down the tracks to accommodate changes in position during installation
- Secure - safety locks ensure security once brackets & tracks are in place
- Space saver – can be multi-tiered to accommodate additional services
- Neat & tidy - system can be 'stacked' on-site to reduce storage



Available in FTB bracket length from 250 mm up to 1 500 mm and in vertical tracks FTT in 285, 535, 785 or 1 035 mm.

3:1 SAFETY FACTOR LOAD RATING	Fast Trak
	180 kg

ACCESSORIES PAGE 69	TECHNICAL PAGE 79	PART CODES PAGE 33
------------------------	----------------------	-----------------------

Installation

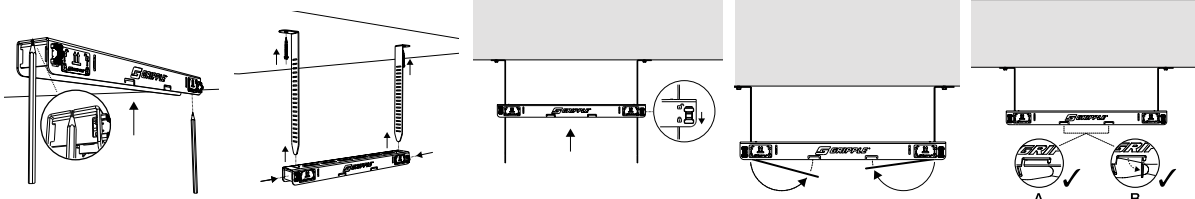

Do not adjust under load.

Kit Codes

How to work out your two product codes

1 CHOOSE YOUR PRODUCT



Bracket
FTB

2 CHOOSE YOUR LENGTH

250	350	450
600	750	900
1 050	1 200	1 500

3 QUANTITY PER BOX

10P

Enter your Bracket product code (e.g. FTB-450-10P):

F	T	B					1	0	P
PRODUCT				LENGTH				QUANTITY PER BOX	

Enter your Track product code (e.g. FTT-285-20P):

F	T	T					2	0	P
PRODUCT				LENGTH				QUANTITY PER BOX	

CB Clip and CT Clip accessories can be ordered to complement the Fast Trak (page 73)

CB Clip

Compatible with 4 mm and 5 mm wire

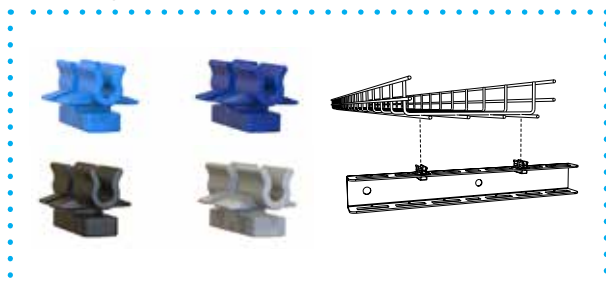

CT Clip

Compatible with 2 mm and 3 mm steel thickness

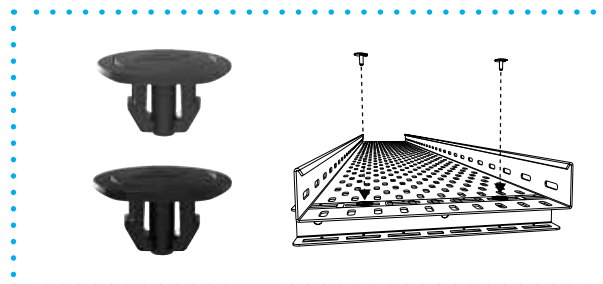

UniGrip

The next generation of wire rope suspension products designed for the fast suspension of cable containment, pipework, ductwork, HVAC systems and multi-tier installations.

- Quick – up to 6 times faster than traditional suspension systems
- Safe – can be pre-installed to channel using pre-fitted washer/nut reducing time working at height
- Easy – integral ergonomically designed release button allows for simple adjustment
- Secure – button acts as a locking screw and indicator clearly highlights the wire is locked in position for ultimate security
- Strong – highest load rating capability to date; up to 250 kg with 5:1 SWL



Available with a range of feet fixings



All hangers are supplied as ready-to-use kits with a length of wire rope and end fixing of your choice.

5:1 SAFETY FACTOR LOAD RATING	No.2	No.3	No.4
	55 kg	110 kg	250 kg

END FIXINGS
PAGE 57

ACCESSORIES
PAGE 69

TECHNICAL
PAGE 79

PART CODES
PAGE 39

Installation

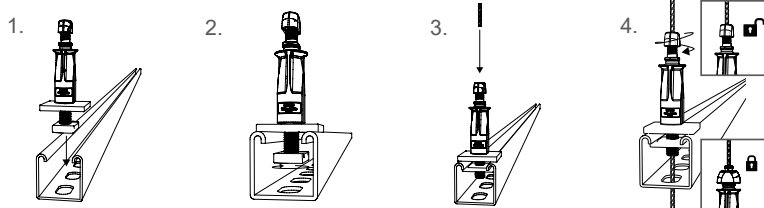

Release

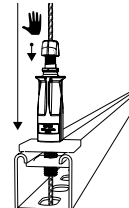

UniGrip Feet

The UniGrip is now even more versatile with a wide range of feet available to suit your application.

Standard

- Designed for non-mechanical fixing through brackets
- Supplied with retention clip for pre-fabrication applications
- Central wire exit



QT

- Designed for use with Gripple Universal Brackets
- Quarter turn installation, no mechanical fix required
- Safety clip for added security
- Central wire exit



Central Exit

- Designed for services suspended with channel
- Supplied with either a square washer and channel nut or hex nut
- 20 mm male thread for mechanical fixing
- Thread sizes - M8 (UniGrip No. 2), M10 (UniGrip No. 3) and M12 (UniGrip No. 4)
- Central wire exit



Side Exit

- Designed for applications in which wire cannot exit centrally (avoiding clashes with services)
- Supplied with a hex nut
- Side wire exit
- Available in M6, M8



Hook

- Self closing latch for security
- Designed for heating/cooling panels and light fittings
- Side wire exit



Calibra

- Designed for adjustment of building services under load
- 35 mm of finite adjustment using integral adjustment pillar and M8 thread
- Side wire exit



Y-Fit

- Designed for lighting or containment
- Dual fixing points for balance
- 150 mm, 300 mm and 500 mm leg lengths as standard
- Legs available with a variety of wire end fixings eg. Toggle, Snap Hook etc.
- Side wire exit



CBA

- Designed for fast suspension of cable baskets (up to 6 mm thickness)
- Eliminates requirement for channel bearers
- Central wire exit



All hangers are supplied as ready-to-use kits with a length of wire rope and end fixing of your choice.

END FIXINGS - PAGE 57

ACCESSORIES - PAGE 69

TECHNICAL - PAGE 79

Trapeze TPZPL

Ideal for fast suspension of rectangular ducting, attenuators and other HVAC applications.

- Simple vertical adjustment using the integral pin prior to applying load
- Spreads the load across four fixing points
- Rubber pad prevents air leakage and dampens vibration
- Conforms to EN 1507 Class D
- Can be used for multi-tiered installations



Available in size No.2

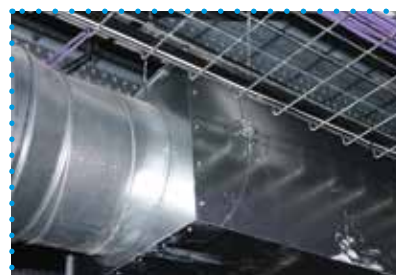

All hangers are supplied as ready-to-use kits with a length of wire rope and end fixing of your choice.

5:1 SAFETY FACTOR LOAD RATING	No.2
	45 kg

END FIXINGS PAGE 57	ACCESSORIES PAGE 69	TECHNICAL PAGE 79	PART CODES PAGE 39
------------------------	------------------------	----------------------	-----------------------

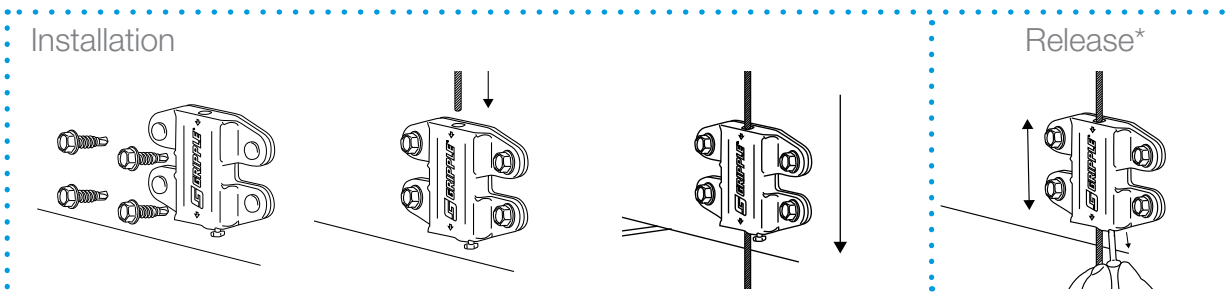

*When releasing: 1. Remove load, 2. Pull tail wire, 3. Activate pin. Screws are not supplied.

Trapeze TPZGR

Ideal for fast suspension of rectangular ducting, attenuators and other HVAC applications.

- Eliminates channel support
- Suitable for ducting made from 0,6 - 1,5 mm gauge steel
- Spreads the load across three fixing points, for self-drilling screws or pop rivets (not provided)
- Rubber pad prevents air leakage and dampens vibration
- Conforms to EN 1507 class D
- Pin allows rapid adjustment



Available in size No.2



All hangers are supplied as ready-to-use kits with a length of wire rope and end fixing of your choice.

5:1 SAFETY FACTOR LOAD RATING	No.2
	45 kg

END FIXINGS
PAGE 57

ACCESSORIES
PAGE 69

TECHNICAL
PAGE 79

PART CODES
PAGE 39

Installation

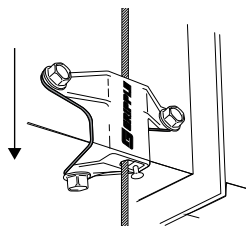
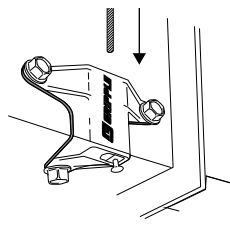
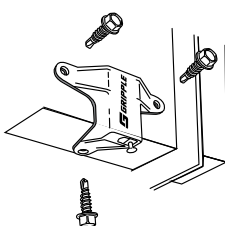

Release*

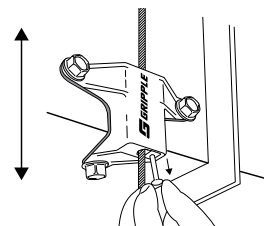

*When releasing: 1. Remove load, 2. Pull tail wire, 3. Activate pin. Screws are not supplied.

Trapeze Plus RF

The Trapeze Plus RF is a fire resistant, aesthetic and professional range to suspend all types of equipment. Its integrated locking system allows you to secure even more your installation.

- Reduced time working at height: Pre-install into channel using the washer / nut supplied
- Perfect levelling: Easy-to-use integral adjustment button
- Security: Tighten the locking screw for ultimate security
- Fire resistant: BRE certified up to 120 minutes
- Multi-tier: Channel can be 'stacked' to optimise space
- Suitable for multiple channel profiles using channel nuts



Available in sizes No.2 - No.3 - No.4
Central Exit



MAXIMUM WORKING LOAD LIMIT ACCORDANCE TO THE NORM DIN 4102 PART 2	No.2	No.3	No.4
	F30 Max: 15 kg F60 Max: 4 kg F120 Max: 2,5 kg	F30 Max: 45 kg F60 Max: 20 kg F120 Max: 10 kg	F30 Max: 100 kg F60 Max: 50 kg F120 Max: 25 kg

END FIXINGS
PAGE 57

ACCESSORIES
PAGE 69

TECHNICAL
PAGE 79

PART CODES
PAGE 39

Installation

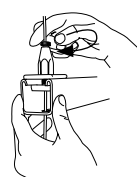
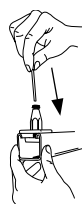
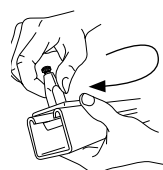
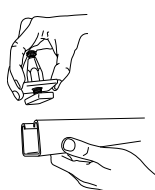

Lock / Release

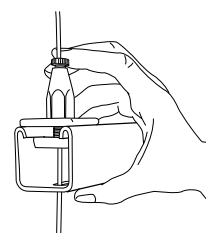

Y-Fit & Y-Fit Accessory

Complete, adjustable single assembly with double hanging points, ideal for cable tray, basket, radiant panels, etc.

- Ideal for cable tray or basket
- One leg can be detached to allow cable installation
- Available with a range of end fixings, and a variety of leg lengths
- Snap Hook version is ideal for use with the G-Bracket
- Accessory version available, ideal for longer drops



Accessory version available

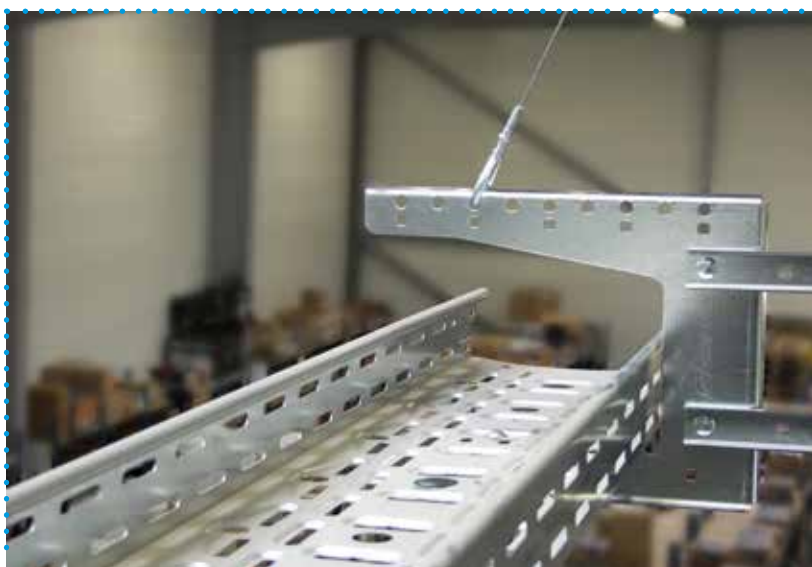

All hangers are supplied as ready-to-use kits with a length of wire rope and end fixing of your choice.

5:1 SAFETY FACTOR LOAD RATING	No.1	No.2	No.3
	15 kg	45 kg	90 kg

END FIXINGS
PAGE 57

ACCESSORIES
PAGE 69

TECHNICAL
PAGE 79

PART CODES
PAGE 41

Installation

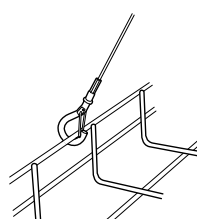
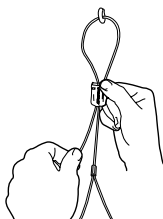
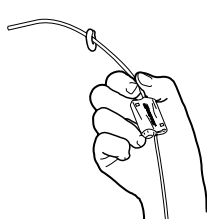

Release

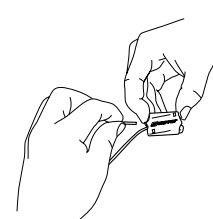

Y-Fit Kit Codes

How to work out your unique product code

1

CHOOSE YOUR PRODUCT



Y-Fit Express
No.1

YX1



Y-Fit Express
No.2

YX2



Y-Fit Classic
No.3

YF3



Y-Fit Accessory
No.1

Y1AJ



Y-Fit Accessory
No.2

Y2AJ



Y-Fit Accessory
No.3

Y3AJ

2

CHOOSE YOUR WIRE LENGTH* (in meter)

1

2

3

4

5

10

*Not available on Y-Fit Accessory

3

CHOOSE YOUR LEG END FIXING



Hook
EC



Link Hook
EM

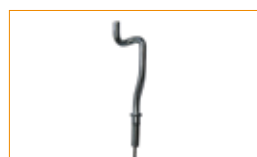

Cable Tray Hook
CT



Toggle
SP

4

CHOOSE YOUR LEG LENGTH

150

300

500

For Y-Fit kit codes enter your unique product code (e.g. YF310FR300):

--	--	--	--	--	--	--	--	--	--	--	--	--

PRODUCT

WIRE LENGTH

LEG END
FIXING

LEG LENGTH

For Y-Fit Accessory kit codes enter your unique product code (e.g. Y1AJ150EC):

--	--	--	--	--	--	--	--	--	--	--	--	--

PRODUCT

LEG LENGTH

LEG END FIXING

For more available End Fixings and further product information please call +33 (0)3 88 95 44 95 or visit our website www.gripple.com for further details.

CTI Kit (indoor)

CTI kit creates secure, overhead spans by running high strength wire rope between two fixing points. Ideal for applications where no direct vertical anchor point is available.

- Visually discreet and lightweight
- Can be fitted retrospectively
- No tools needed to install
- Available in 3 mm and 6 mm wire rope diameters, for suspensions up to 100 kg per span
- C-Clip End Fixing allows horizontal and vertical adjustment
- Cams lock solidly in place, even at angles up to 60°

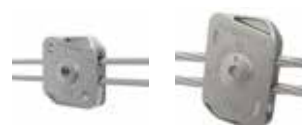

CTI 3

CTI 6



Supplied as ready-to-use kits, including galvanised wire rope cut to bespoke lengths, a hex locking and a release key.

5:1 SAFETY FACTOR LOAD RATING FREE SPAN	CTI3	CTI6
	30 kg	100 kg

TECHNICAL
PAGE 79

C-CLIP
PAGE 64

ACCESSORIES
PAGE 72

Installation

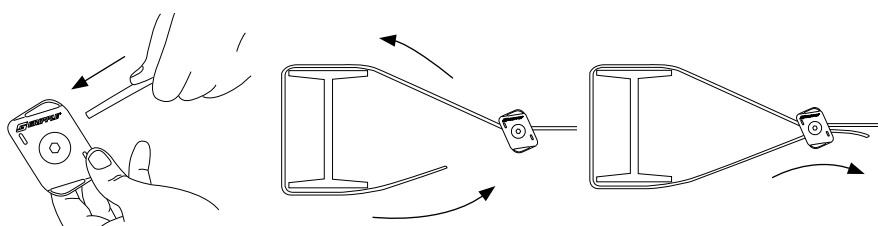

Lock / Release

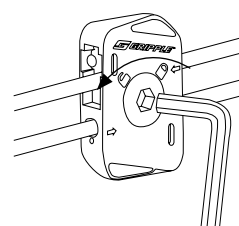

CTI Kit Codes

How to work out your unique product code

1

CHOOSE YOUR PRODUCT

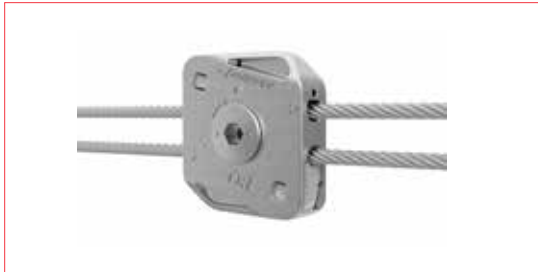

CTI3
for 3 mm wire rope
CTI3



CTI6
for 6 mm wire rope
CTI6

2

CHOOSE YOUR WIRE LENGTH (in meter)

4	6	8	10	15	20	25	30	35	40
---	---	---	----	----	----	----	----	----	----

Enter your unique product code (e.g. CTI330):

C	T	I				
PRODUCT				WIRE LENGTH		

C-Clip End Fixing can be ordered to complement the CTI Kit on the hanger product code pages 31 or 39



C-Clip 3 mm
CC3

C-Clip 6 mm
CC6

CTI Wall Bracket and GF Bracket are available to complement the CTI Kit using the codes below



PLAT100



GRIPPROFIL613

For further product information please call +33 (0)3 88 95 44 95 or visit our website www.gripple.com for further details.

EP Kit (outdoor)

EP Kit creates secure, overhead spans by running high strength cables horizontally between two fixed points. Ideal for suspending Christmas decorations, advertising banners, public lighting, etc. or for creating temporary cable trays.

- Quick installation replacing turnbuckle and wire strainers
- Suitable for use in outdoor dynamic installations
- Ready to use
- Reduces time spent working at height
- Easy to store and handle
- Available up to 100 kg SWL, with a 5:1 safety factor



EP6



Supplied as ready-to-use kits, including galvanised wire rope cut to bespoke lengths, a hex locking and a release key.

5:1 SAFETY FACTOR LOAD RATING FREE SPAN	EP6
	100 kg

TECHNICAL
PAGE 79

C-CLIP
PAGE 64

ACCESSORIES
PAGE 72

Installation

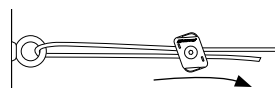
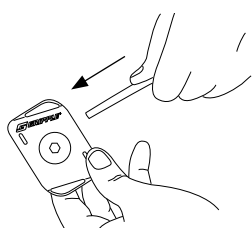

Lock / Release

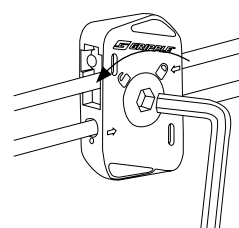

Kit codes

How to work out your unique product code

1

YOUR PRODUCT



EP6
for 6 mm wire rope
EPLO

2

CHOOSE YOUR WIRE LENGTH (in meter)

10

15

20

Enter your unique product code (e.g. EPLO106):

E

P

L

O

6

PRODUCT

WIRE LENGTH

C-Clip Accessory can be ordered to complement the EP Kit using the code below:



C-Clip accessory outdoor for 6 mm wire rope

ACCEP6

Wall Bracket is available to complement the EP Kit using the code below



PLAT100

For further product information please call +33 (0)3 88 95 44 95 or visit our website www.gripple.com for further details.

PB Kit

The PB Kits come in a DIY kit with quarter turn Twist clamps QT for quick and easy support of pipework within mechanical and plumbing services.

- Up to 6 times faster
- Supplied in kit to assemble by yourself
- Versatile, can be bolted directly to soffit or wall, or suspended at a length from the soffit
- Saves labour time - Eliminates the need for cutting channel on site, allowing more productive use of labour
No tools or “Hot Works” permit required for installation
- Compatible - Integrates with UniGrip – QT (page 35)



Supplied in ready-to-use kits with PB Bracket sizes 240, 340, 640, 1 040 and 1 240 mm.

5:1 SAFETY FACTOR LOAD RATING	PB KIT
	90 kg (between supports)

ACCESSORIES
PAGE 69

TECHNICAL
PAGE 79

PART CODES
PAGE 49

Installation

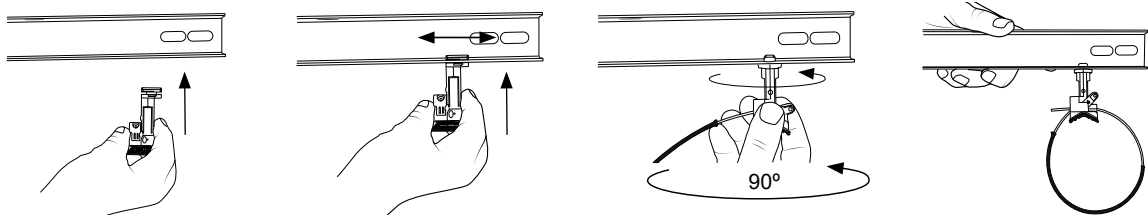

LPB Kit

Low Profile Bracket kits are supplied with Quick Twist Compact Clamps for quick and easy support of pipework within mechanical and plumbing services.

- Quick and easy installation - Low Profile Brackets are supplied with universal Quick Twist Compact Clamps featuring quarter turn fixing
- Versatile - bolted directly to soffit or wall
- Saves labour time - Eliminates the need for cutting channel on site, allowing more productive use of labour
- Universal - For pipe sizes Øext. 17 mm to Øext. 89 mm
- Improves health and safety - No tools or “Hot Works” permit required for installation

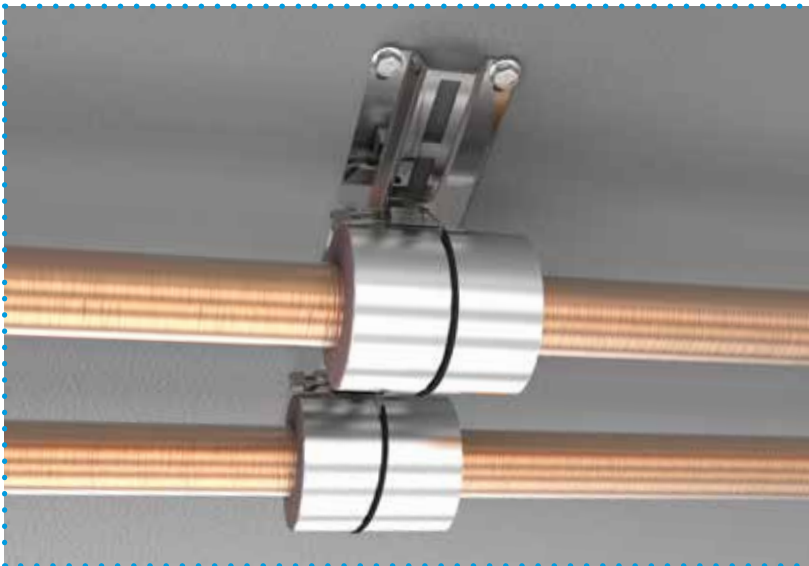

Supplied in ready-to-use kits with LPB Bracket sizes 180, 350, 650, 950 and 1 250 mm.

5:1 SAFETY FACTOR LOAD RATING	LPB KIT
	90 kg (between supports)

ACCESSORIES PAGE 69	TECHNICAL PAGE 79	PART CODES PAGE 49
------------------------	----------------------	-----------------------

Installation

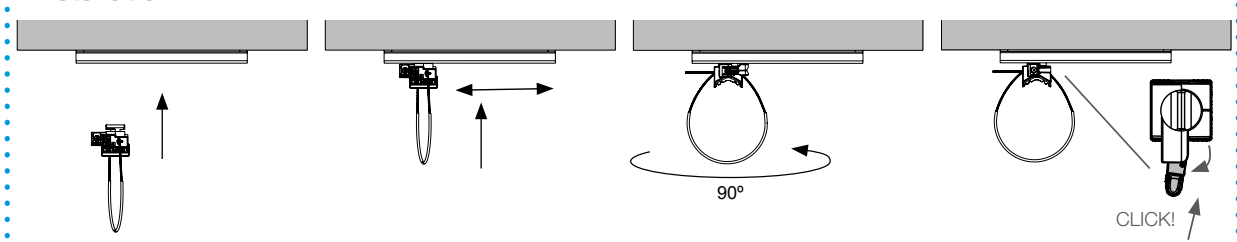

PFT Kit

Pre-fabricated, trapeze bracket solution offering speed, flexibility and efficient use of space, for the installation of pipework in restricted places.

- Quick - up to six times faster to install than traditional suspension systems
- Suitable for pipe sizes Øext. 17 mm to Øext. 89 mm
- Safe - pre-fabricated system which removes the need to cut threaded rod or channel on site
- Tool free - bracket can be moved up and down the tracks to accommodate changes in position during installation
- Secure - safety locks ensure security once brackets & tracks are in place
- Space saver – can be multi-tiered to accommodate additional services
- Neat & tidy - system can be 'stacked' on-site to reduce storage



Available in FTB bracket length from 250 mm up to 1 500 mm and in vertical tracks FTT in 285, 535, 785 or 1 035 mm.

3:1 SAFETY FACTOR LOAD RATING	PFT KIT
	180 kg

ACCESSORIES
PAGE 69

TECHNICAL
PAGE 79

PART CODES
PAGE 49

Installation

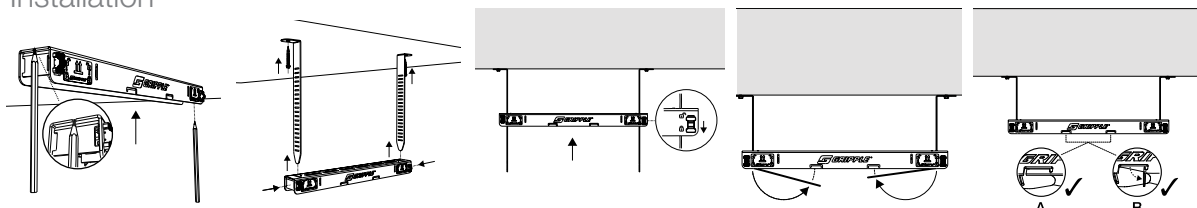

Pipework Kit Codes

How to work out your unique product code

1

CHOOSE YOUR PIPE BRACKET

PIPE BRACKET



240 mm PB24 340 mm PB34 640 mm PB64 1 040 mm PB104 1 240 mm PB124

LOW PIPE BRACKET



180 mm LPB18 350 mm LPB35 650 mm LPB65 950 mm LPB95 1 200 mm LPB120

HORIZONTAL BRACKETS (PFT)



250 mm PFT25 350 mm PFT35 450 mm PFT45 600 mm PFT60 750 mm PFT75 900 mm PFT90

VERTICAL TRACKS

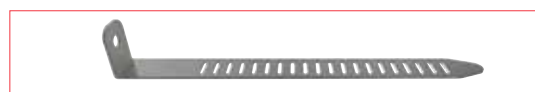

285 mm A 535 mm B 785 mm C 1 035 mm D

2

CHOOSE YOUR CLAMP QUANTITY

2

3

4

5

6

7

8

3

CHOOSE YOUR TYPE OF CLAMP



QT Universal Clamp
QT



QT Compact Clamp
QTC

Enter your unique product code (e.g. PFT45A3QT400):

						-		-				-	4	0	0
--	--	--	--	--	--	---	--	---	--	--	--	---	---	---	---

PIPE BRACKET

CLAMP
QUANTITY

TYPE OF CLAMP

WIRE LENGTH
(MM)

For further product information please call +33 (0)3 88 95 44 95 or visit our website www.gripple.com for further details.

CRUFLEX

The CRUFLEX pipe support systems provide rapid installation, ensuring insulation continuity without the conventional associated thermal breaks.

- Designed specifically for use with Gripple pipe clamps
- Space saving - advantageous for applications in confined spaces or areas where space is at a premium
- Universal - suitable for mild steel, stainless steel, copper and plastic pipes in a range of sizes
- High performance - reduced heat loss & highly moisture resistant
- Temperature range: -50 °C to + 110 °C
- Thermal conductivity: 0,034 W/(m.k) at 10 °C
- Available up to 35 kg SWL, with a 5:1 safety factor



Insulation thickness: 19, 25 or 32 mm. For other diameters, please contact our sales department.

ACCESSORIES
PAGE 69

TECHNICAL
PAGE 79

PART CODES
PAGE 55

Installation

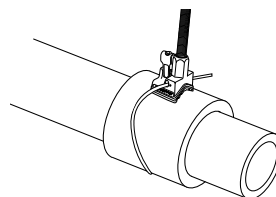
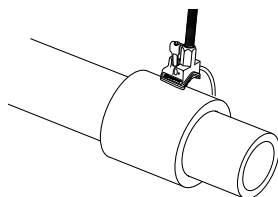
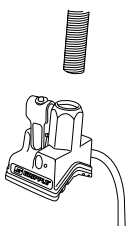

Lock / Release

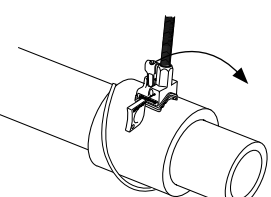

CRUPHEN

The CRUPHEN pipe support systems provide rapid installation, ensuring insulation continuity without the conventional associated thermal breaks.

- Designed specifically for use with Gripple pipe clamps
- Space saving - advantageous for applications in confined spaces or areas where space is at a premium
- Universal - suitable for mild steel, stainless steel, copper and plastic pipes in a range of sizes
- High performance - reduced heat loss & highly moisture resistant
- Temperature range: -50 °C to + 110 °C
- Thermal conductivity: 0,036 W/(m.k) at 10 °C
- Available up to 35 kg SWL, with a 5:1 safety factor



Insulation thickness: 15, 20, 25, 30, 40 or 50 mm. For other diameters, please contact our sales department. Supplied with a metal spreader plate for Ø above 25 mm

ACCESSORIES
PAGE 69

TECHNICAL
PAGE 79

PART CODES
PAGE 55

Installation

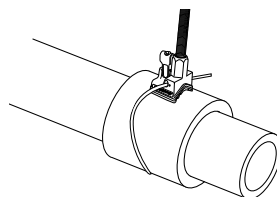
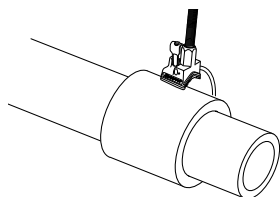
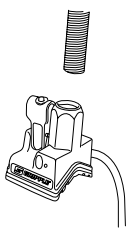

Lock / Release

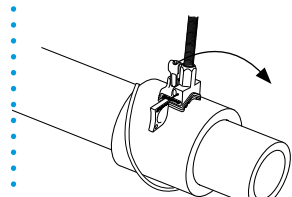

Universal Clamp Pipework

The Universal Clamp is engineered for hanging all types of pipework within mechanical and plumbing services.

- Up to 6 times faster than traditional methods
- Suitable for pipe sizes Øext. 17 mm to Øext. 89 mm
- Replaces more than 11 different pipe ring sizes
- Retractable, removable sleeve is pre-fitted to wire rope to prevent galvanic corrosion
- Improved insulation against vibration
- Easy site storage, reduces waste
- Simplifies 'take-off' process
- Available up to 75 kg SWL, with a 3:1 safety factor



Supplied individually or as part of a Y-Pipe system to suit your application.

Available pads

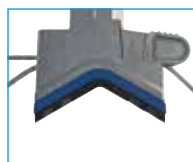

Standard

Rubber pad for insulation purposes
14 dBa reduction.



Large

Improved fit for large dia. pipe
Most suitable for 3" and above 18 dBa reduction.



Acoustic

Designed to reduce noise related to water pressure
23 dBa reduction

Clamps are supplied as ready-to-use kits with Universal or Low Profile Brackets available in various sizes.

Installation

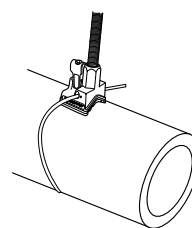
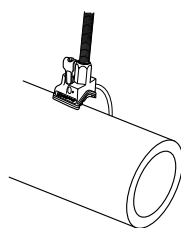
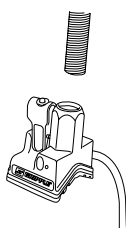

Lock / Release

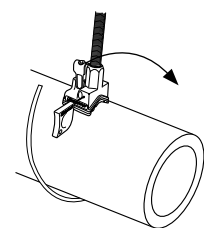

Accessories
Page 69

Technical
Page 79

Product codes
Page 55

Universal Clamp Waste water

Introducing the Gripple Universal Clamp for PE, PP and PVC pipes, used for securing all types of waste water pipework within plumbing services.

- Fast: 4 times faster than traditional pipe rings
- Universal: for PE, PP and PVC pipe sizes from Ø 25 to Ø 200
- Versatile: replaces more than 11 different sizes of pipe ring
- Flexible: simplifies take off process
- Easy site storage, reduces waste
- Vibration reduction (conforms to the DIN 4109)
- Strong and robust: one piece die-casting, no screws to lose on site
- Available up to 75 kg SWL, with a 3:1 safety factor



Supplied individually or as part of a bespoke bracket system to suit your application.

Available pads

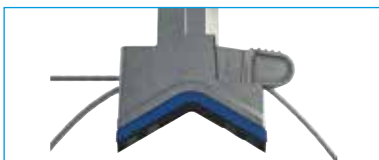

Standard
Rubber pad for
insulation purposes
14 dBa reduction.



Large
Improved fit for
large dia. pipe
Most suitable for 3"
and above 18 dBa
reduction.

Clamps are supplied as ready-to-use kits with Universal or Low Profile Brackets available in various sizes.

Installation

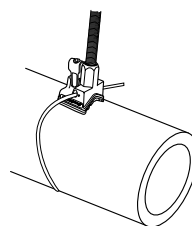
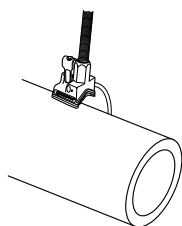
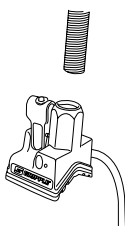

Lock / Release

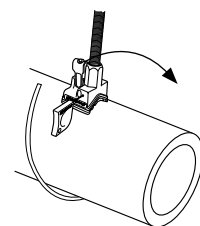

Accessories
Page 69

Technical
Page 79

Product codes
Page 55

Universal Clamp Ductwork

Introducing the Universal Clamp for Spiral Ducting, used for hanging all types of spiral ductwork within HVAC.

- Up to 6 times faster than traditional methods
- Replaces more than 13 different suspension ring sizes
- Single piece cast construction - not welded
- No tools required for installation
- No risk of losing screws on site
- Inherent vibration insulating properties from the wire rope
- Easy site storage, reduces waste
- Easy to calculate the quantity on a project plan
- Available up to 75 kg SWL, with a 3:1 safety factor



Supplied individually in two length 1,5 m for Ø80 to Ø355 mm or 2,5 m for Ø400 to Ø710 mm to suit your application.

Available pads

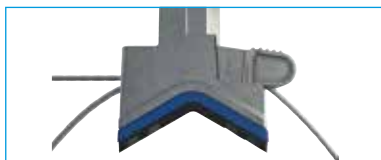

Standard
Rubber pad for
insulation purposes
14 dBa reduction.



Large
Improved fit for
large dia. pipe
Most suitable for 3"
and above 18 dBa
reduction.

Clamps are supplied as ready-to-use kits with Universal or Low Profile Brackets available in various sizes.

Installation

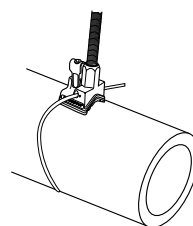
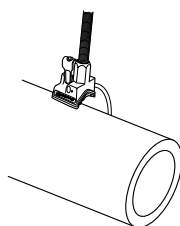
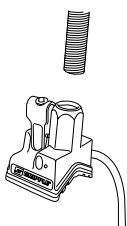

Lock / Release

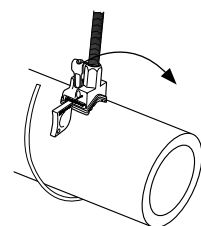

Accessories
Page 69

Technical
Page 79

Product codes
Page 55

Universal Clamps Codes

UNIVERSAL CLAMPS



Universal clamp for waste water
GC2M800E



Universal clamp for pipework
GC2M400A



Universal clamp for ductwork
GC2M8M10L1500V (Ø80 to Ø355 mm)
GC2M8M10L2500V (Ø400 to Ø710 mm)

PIPE INSULATION KIT

CRUFLEX	Product codes	OD	NPS	ND
		mm	in	mm
 <p>For hot, cold water and air conditioning pipes</p>	GC214E XX CF	13,5	1/4	8
	GC217E XX CF	17,2	3/8	10
	GC221E XX CF	21,3	1/2"	15
	GC227E XX CF	26,9	3/4"	20
	GC234E XX CF	33,7	1"	25
	GC242E XX CF	42,4	1 1/4"	32
	GC249E XX CF	48,3	1 1/2"	40
	GC254E XX CF	54	2 1/8"	-
	GC260E XX CF	60,3	2"	50
	GC264E XX CF	64	2 1/2"	-
	GC276E XX CF	76,1	2 1/2"	65
	GC289E XX CF	88,9	3"	80

XX = refers to insulation thickness, options are 19, 25 or 32 mm. For other diameters, please contact our sales department.

CRUPHEN	Product codes	OD	NPS	ND
		mm	in	mm
 <p>For chilled water pipes</p>	GC214E XX CP	13,5	1/4	8
	GC217E XX CP	17,2	3/8	10
	GC221E XX CP	21,3	1/2"	15
	GC227E XX CP	26,9	3/4"	20
	GC234E XX CP	33,7	1"	25
	GC242E XX CP	42,4	1 1/4"	32
	GC249E XX CP	48,3	1 1/2"	40
	GC254E XX CP	54	2 1/8"	-
	GC260E XX CP	60,3	2"	50
	GC267E XX CP	66,7	-	-
	GC276E XX CP	76,1	2 1/2"	65
	GC289E XX CP	88,9	3"	80

XX = refers to insulation thickness, options are 15, 20, 25, 30, 40 or 50 mm. For other diameters, please contact our sales department.

* Supplied with a metal spreader plate for diameters superior to Ø25 mm.





End Fixings

Loop & Stud	page 58
Toggle & Cladding Hook	page 59
Mini Hook & Hook	page 60
Twist Clip (white) & Top Hat	page 61
Magnetic Pad & Eyelet	page 62
45° Eyelet & 90° Eyelet	page 63
C-Clip & Barrel	page 64
Shot Fire (Powder) & Shot Fire (Gas)	page 65
Channel Nut & End Stop	page 66
QT Barrel & Cable Tray Hook	page 67

Loop

- Hanger using a non-invasive, simple, choke knot technique. No need for nuts, bolts, clamps or other accessories
- Available up to 325 kg SWL, with up to a 5:1 safety factor
- Comes as a ready-to-use kit with Gripple wire rope and hanger
- Available in lengths of 1 m - 10 m
- Available in Stainless Steel



Available Hangers

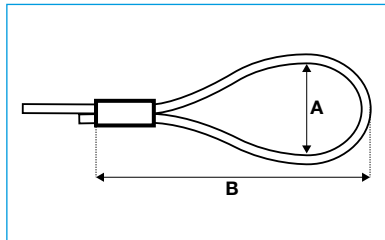

Installation

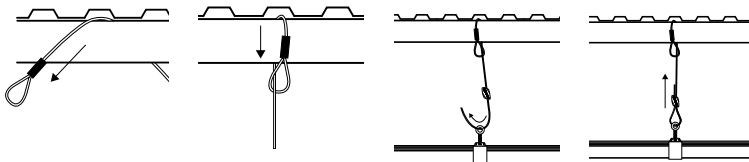

Size	A (mm) Indicative	B (mm) Indicative
No.1 (0 - 15 kg)	30	60
No.2 (15 - 45 kg)	30	60
No.3 (45 - 90 kg)	25	60
No.4 (90 - 225 kg)	45	85
No.5 (225 - 325 kg)	45	90

Install fixings in accordance with manufacturer's specifications.

Stud

- Supplied with Drop-in Anchors
- Available in M6, M8 and M10, up to 225 kg SWL, with up to a 5:1 safety factor
- Supplied as a ready-to-use kit with Gripple wire rope and hanger
- Available in lengths from 1 m - 10 m
- Other lengths are available on request
- Also available in Stainless Steel



Available Hangers

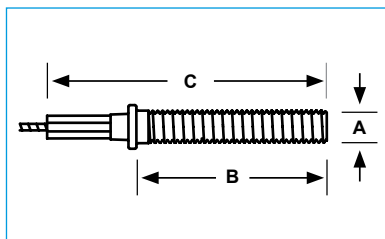
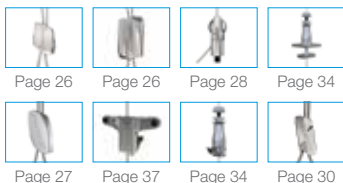

Installation

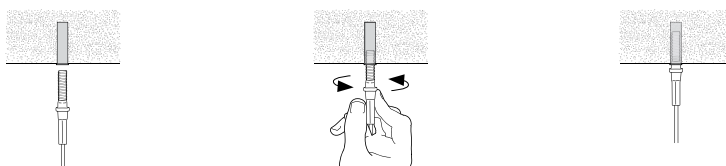

Size	A	B (mm)	C (mm)
No.1 (0 - 15 kg)	M6	20	48
No.2 (15 - 45 kg)	M6	20	48
	M8	45	70
No.3 (45 - 90 kg)	M8	45	77
	M10	45	77
No.4 (90 - 225 kg)	M10	45	77

Install fixings in accordance with manufacturer's specifications.

Toggle

- Ideal when used as a Y-Fit to suspend lighting
- Available up to 90 kg SWL, with up to a 5:1 safety factor
- Comes as a complete kit with Gripple wire rope and hanger
- Available in Stainless Steel
- Available in lengths from 1 m - 10 m

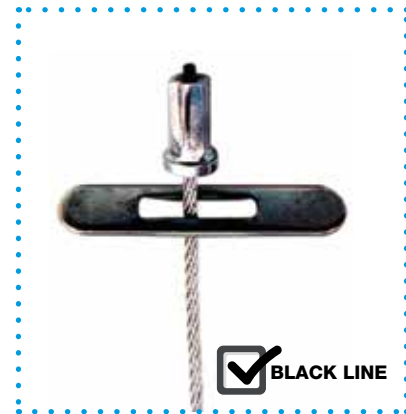

Available Hangers

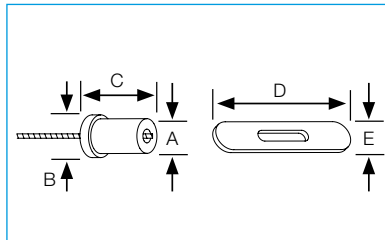
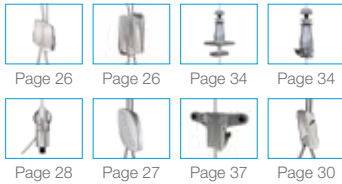

Size	A Ø (mm)	B Ø (mm)	C (mm)	D (mm)	E (mm)
No.1 (0 - 15 kg)	4,2	5,9	8	40	5,8
No.2 (15 - 45 kg)	6,2	7,9	12	40	7,8
No.3 (45 - 90 kg)	6,2	9,9	18	40	9,7

Installation

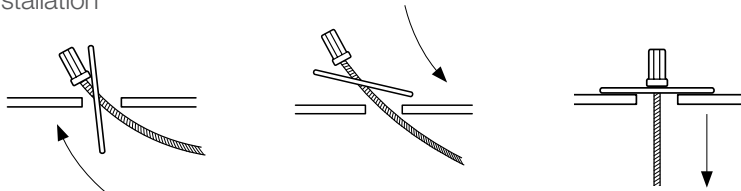

Install fixings in accordance with manufacturer's specifications.

Cladding Hook

- Designed to fit 6 mm holes
- Suitable for every grade of steel
- Comes as a ready-to-use kit with Gripple wire rope and hanger
- Creates a secure hanger
- Safe working load may vary dependent on the thickness of steel to which it is attached
- Available in lengths of 1 m - 10 m



Available Hangers

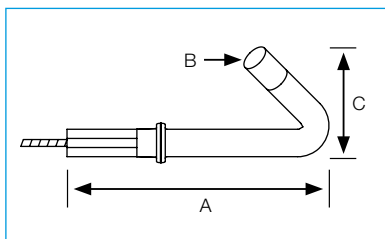
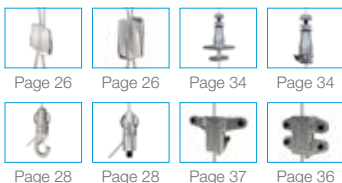

Size	A (mm)	B (mm)	C (mm)
No.1 (0 - 15 kg)	59	Ø 5	24
No.2 (15 - 45 kg)	59	Ø 5	24

5:1 safety factor based on 2 mm thick cladding. Install fixings in accordance with manufacturers' specifications.

Installation

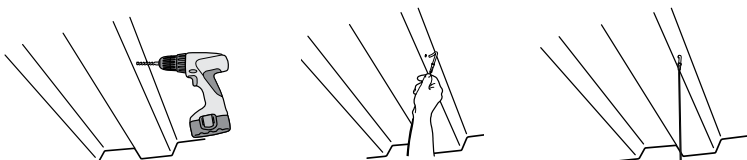

Mini Hook

- Ideal for services that require access or maintenance
- Available up to 15 kg SWL, with a 5:1 safety factor
- Comes as a ready-to-use kit with Gripple wire rope and hanger
- Standard lengths 1 m - 10 m
- Other lengths are available upon request

Available Hangers



Page 26



Page 28



Page 28

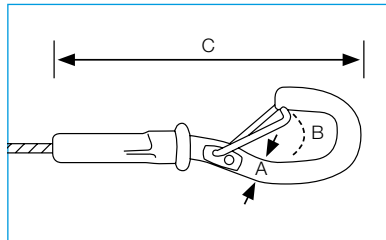

Size	A (mm)	B (mm)	C (mm)
No.1 (0 - 15 kg)	4,5	5	55

Install fixings in accordance with manufacturer's specifications.

Installation

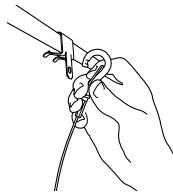

Hook

- Quick and easy attachment to cable basket, purlin clips, light fittings
- Available up to 90 kg SWL, with up to a 5:1 safety factor
- Comes as a ready-to-use kit with Gripple wire rope and hanger
- Available in lengths from 1 m - 10 m
- Other lengths are available on request

Available Hangers



Page 26



Page 26



Page 34



Page 34



Page 28



Page 27



Page 37



Page 36

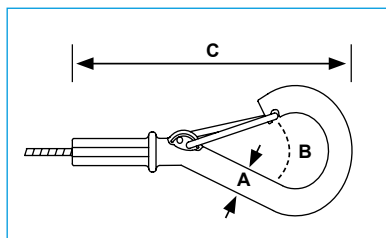

Size	A (mm)	B (mm)	C (mm)
No.1 (0 - 15 kg)	6,3	7	75
No.2 (15 - 45 kg)	6,3	7	75
No.3 (45 - 90 kg)	6,3	7	75

Install fixings in accordance with manufacturer's specifications.

Installation

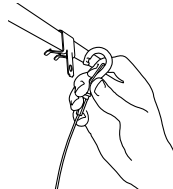

Twist Clip (White)

- Designed for use on 24 mm T-Bar grid ceilings
- Quick and easy to install - no tools required
- Visually discreet and lightweight
- Can be retrofitted and will not cause damage to the T-Bar grid
- Available up to 5 kg SWL
- Available as part of a ready-to-use kit

Available Hangers



Page 28



Page 28



Page 28

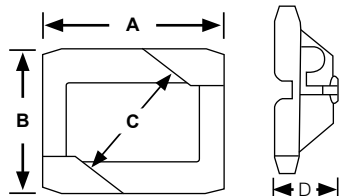

Size	A (mm)	B (mm)	C (mm)	D (mm)
No.1 (0 - 5 kg)	40	32	24	15

Install fixings in accordance with manufacturer's specifications.

Installation

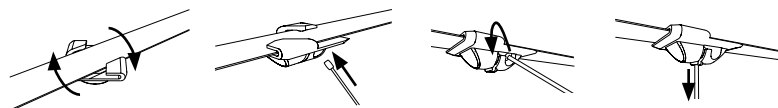

Top Hat

- Aesthetic fixing for use with a wide range of Gripple hangers
- Ideal when lighting/services are exposed
- Available up to 45 kg SWL with up to a 5:1 safety factor
- Two part construction for fast installation using M6 or Ø 4,5 mm c/sunk screws (page 71)
- Supplied as a ready-to-use kit with Gripple wire rope and hanger

Available Hangers



Page 28



Page 28



Page 28

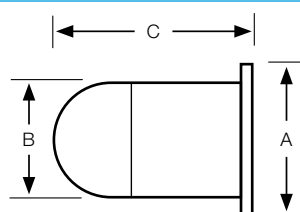

☒ **BLACK LINE**

Size	A (mm)	B (mm)	C (mm)
No.1 (0 - 15 kg)	18	14	26
No.2 (15 - 45 kg)	18	14	26

Install fixings in accordance with manufacturer's specifications.

Installation

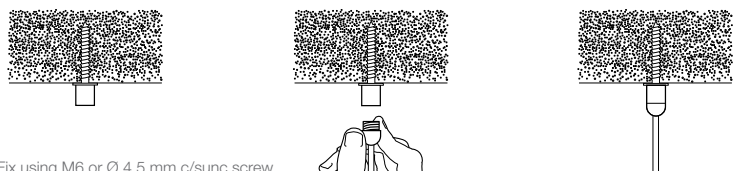

Fix using M6 or Ø 4,5 mm c/sunk screw.

Magnetic Pad

- Ideal for hanging signage and fixing services to ferrous metal surfaces
- Available up to 8 kg SWL, with a 2:1 safety factor
- Load is affected by the metal thickness and surface condition (painted finish)
- Not for use on aluminium, brass or non-metallic products
- Comes as a ready-to-use kit with Gripple wire rope and hanger

Available Hangers



Page 28

Page 28

Page 28

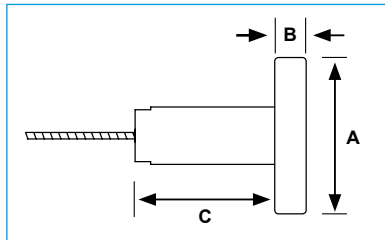

Size	A (mm)	B (mm)	C (mm)
No.1 (0 - 8 kg)	25	8	45

Install fixings in accordance with manufacturer's specifications.
A test must be carried out on site before any installation to validate that the steel can support the load.

Installation

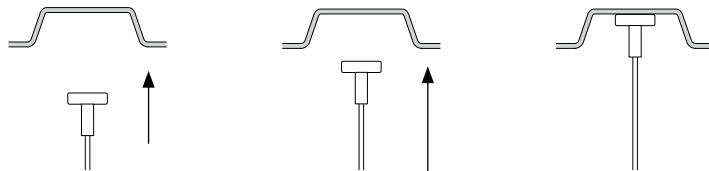

Eyelet

- Available up to 90 kg SWL, with up to a 5:1 safety factor
- Comes as a ready-to-use kit with Gripple wire rope and hanger
- Fire Rated version available
- Available in lengths from 1 m - 10 m

Available Hangers

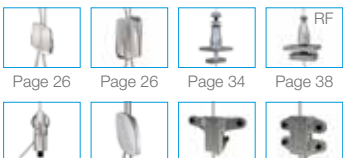

Page 26

Page 26

Page 34

Page 38



Page 28

Page 27

Page 37

Page 36

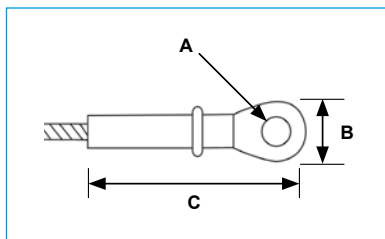

BLACK LINE

Size	A (mm)	B (mm)	C (mm)
No.1 (0 - 15 kg)	6,5	11	45
No.2 (15 - 45 kg)	6,5	11	45
No.3 (45 - 90 kg)	6,5	11	45

Install fixings in accordance with manufacturer's specifications.

Installation

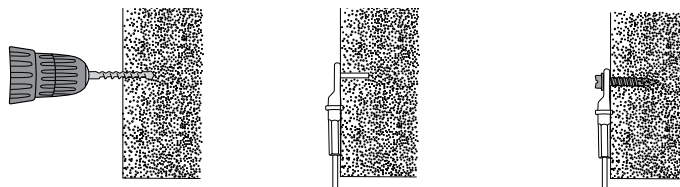

45° Eyelet

- Ideal for use in bracing applications
- Available up to 90 kg SWL, with up to a 5:1 safety factor
- Comes as a ready-to-use kit with Gripple wire rope and hanger
- Available in lengths from 1 m - 10 m



Available Hangers



Page 26

Page 27

Page 27

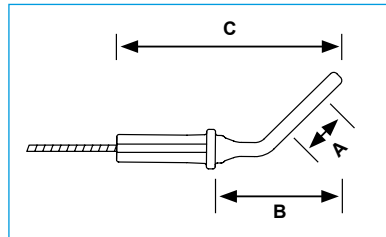

Size	A (mm)	B (mm)	C (mm)
No.2 (0 - 45 kg)	11,2	29	52
No.3 (45 - 90 kg)	11,2	29	52

Install fixings in accordance with manufacturer's specifications.

Installation

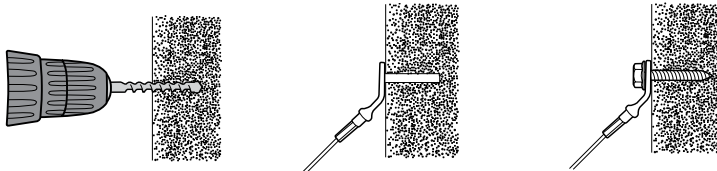

90° Eyelet

- Ideal for use with Gripple concrete screws for direct soffit mounting
- Available up to 90 kg SWL, with up to a 5:1 safety factor
- Comes as a ready-to-use kit with Gripple wire rope and hanger
- Fire Rated version available
- Available in lengths from 1 m - 10 m



Available Hangers

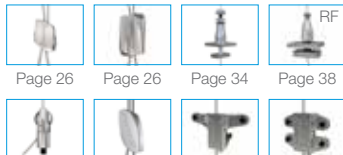

Page 26

Page 26

Page 34

Page 38

Page 28

Page 27

Page 37

Page 36

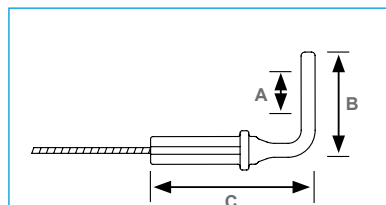

Size	A (mm)	B (mm)	C (mm)
No.1 (0 - 15 kg)	7,5	25	38
No.2 (15 - 45 kg)	7,5	25	38
No.3 (45 - 90 kg)	7,5	25	38

Install fixings in accordance with manufacturer's specifications.

Installation

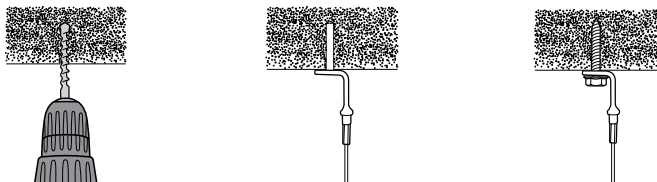

C-Clip

- Up to 10 times faster to install
- Allows horizontal and vertical adjustment
- Cams lock solidly in place even at angles up to 60°
- 3 mm and 6 mm versions available
- Available up to 45 kg SWL with up to a 5:1 safety factor
- Comes as a ready-to-use kit with Gripple wire rope and hanger
- Can be retrofitted
- One handed installation, no tools required
- Designed for use with CTI Kits (page 42)



Available Hangers

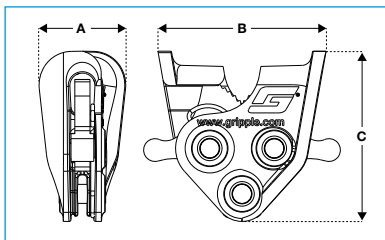
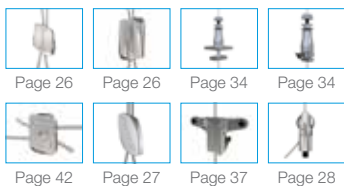

Size	A (mm)	B (mm)	C (mm)
3 mm (0 - 15 kg)	12	26	33
6 mm (0 - 45 kg)	23	45	45

Install fixings in accordance with manufacturer's specifications.

Installation

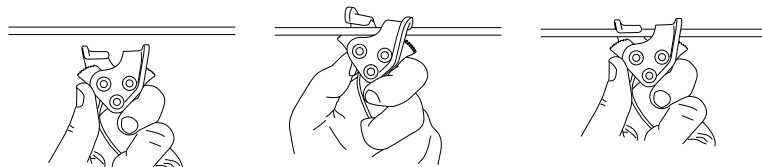

Barrel

- Ideal for use on signage, or exposed services, such as retail and office environments
- Available up to 90 kg SWL, with up to a 5:1 safety factor
- Comes as a ready-to-use kit with Gripple wire rope and hanger
- Available in lengths from 1 - 10 m



Available Hangers

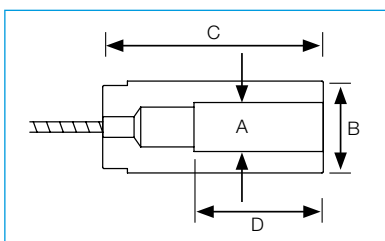
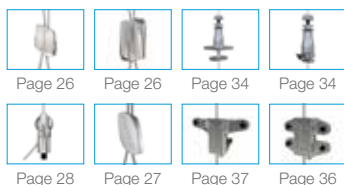

Size	A (mm)	B (mm)	C (mm)	D (mm)
No.1 (0 - 15 kg)	M6	12	45	26
No.2 (15 - 45 kg)	M6 & M8	12	45	26
No.3 (45 - 90 kg)	M8	12	45	26

Install fixings in accordance with manufacturer's specifications.

Installation

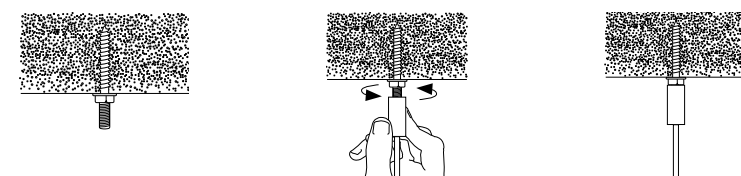

Shot Fire (Powder)

- Six times faster than traditional methods (drilling and anchoring)
- Can be used with powder fastening tools (DX460 and BX3)
- Quick and easy fastening solution
- Supplied as a ready-to-use kit
- Available with 22 and 27 mm nail length
- Available in lengths from 1 to 10 m



Available Hangers



Page 28

Page 26

Page 26



22 mm

27 mm

Nail Clip	Shank diameter (mm)	Shank length (mm)	Head diameter (mm)
DX22	4,0	22	8,0
DX32	4,0	27	8,0

Install fixings in accordance with manufacturer's specifications.

Installation

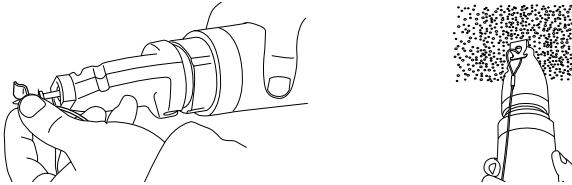

Shot Fire (Gas)

- Six times faster than traditional methods (drilling and anchoring)
- Can be used with gas fastening tools (P800E, GX120 and BX3)
- Quick and easy fastening solution
- Supplied as a ready-to-use kit
- Available in lengths from 1 to 10 m



Available Hangers



Page 28

Page 26

Page 26

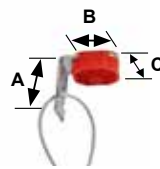

For use with
P800E, GX120, BX3

Nail clip	A (mm)	B (mm)	C (mm)
CG	31	25	18

Install fixings in accordance with manufacturer's specifications.

Installation

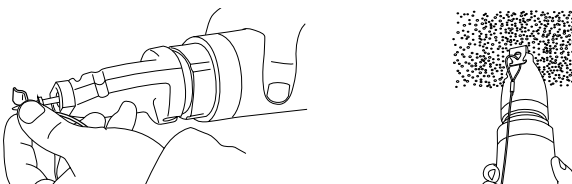

Channel Nut

- Fast to install
- Pre-assembled and ready-to-insert
- Fits directly into the channel
- Available up to 90 kg SWL with up to a 5:1 safety factor
- Fits both 41 x 41 and 41 x 21 channel
- Ideal for common rail installations
- Ideal for multi-tier installations
- No additional components required

Available Hangers

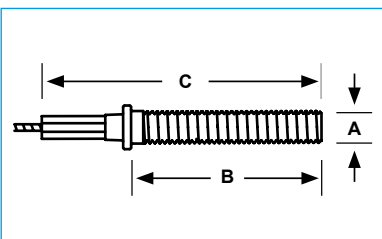
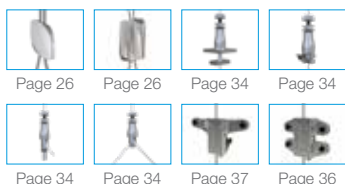

Size	A Ø	B (mm)	C (mm)
No.2 (0 - 45 kg)	M8	45	70
No.3 (45 - 90 kg)	M8	45	70

Install fixings in accordance with manufacturer's specifications.

Installation

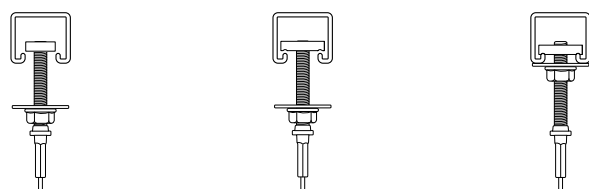

End Stop

- Simple, fast installation for extruded profiles
- Available up to 90 kg SWL, with up to a 5:1 safety factor
- Comes as a complete kit with Gripple wire rope and hanger
- Available in lengths from 1 - 10 m



Available Hangers

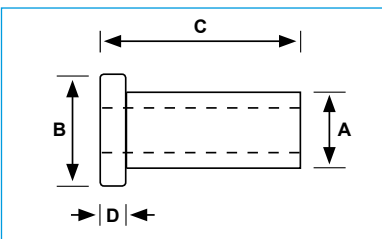
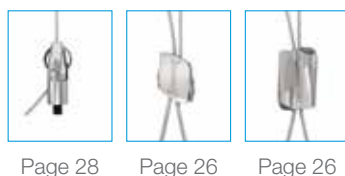

Size	A (mm)	B (mm)	C (mm)	D (mm)
No.1 (0 - 15 kg)	4,2	5,7	9	2
No.2 (15 - 45 kg)	6,2	7,8	13,8	2
No.3 (45 - 90 kg)	6,2	9,8	19	2,8

Install fixings in accordance with manufacturer's specifications.

Installation

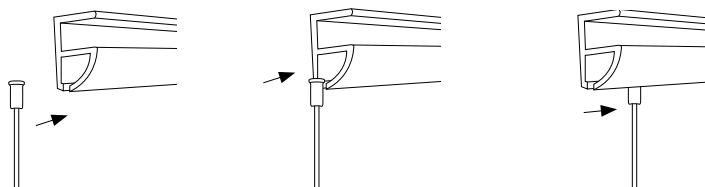

QT Barrel

- Fast quarter turn attachment to Gripple Brackets
- Available up to 90 kg SWL, with up to a 5:1 safety factor
- Allows for suspension of services from pre-installed header rails or to provide multi-tier suspension from Gripple Universal Brackets



Available Hangers

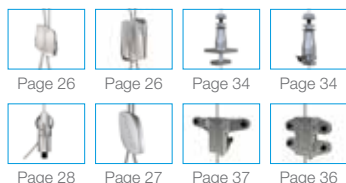

Page 26

Page 26

Page 34

Page 34

Page 28

Page 27

Page 37

Page 36

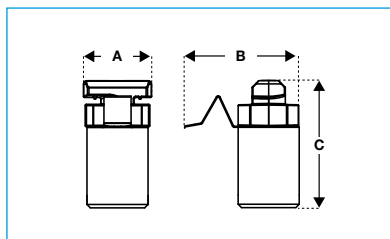

Size	A (mm)	B (mm)	C (mm)
No.1 (0 - 15 kg)	20	34	37,5
No.2 (15 - 45 kg)	20	34	37,5
No.3 (45 - 90 kg)	20	34	37,5

Install fixings in accordance with manufacturer's specifications.

Installation

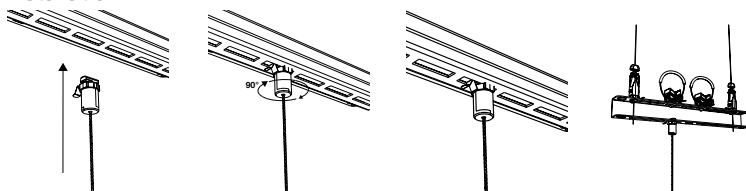

Cable tray hook

- Ideal for use with cable tray
- Available up to 45 kg SWL, with a 4:1 safety factor
- Comes as a ready-to-use kit with the Y-Fit product (page 40)



Available Hangers

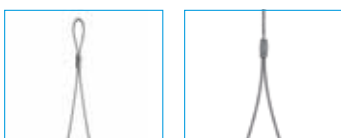

Page 40

Page 40

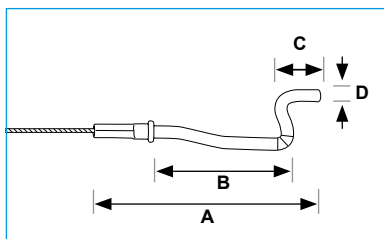

Size	A (mm)	B (mm)	C (mm)	D (mm)
Y-Fit (0 - 45 kg)	92	60	19	5

Install fixings in accordance with manufacturer's specifications.

Installation

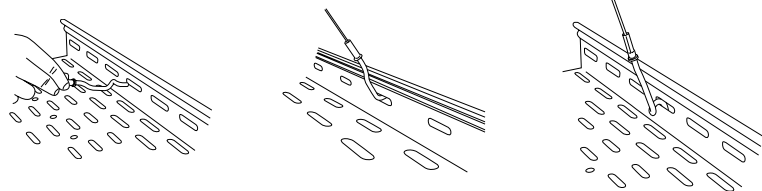



Accessories

Anchoring Solutions	page 70
Beams & Purlins	page 72
Brackets & Attachments	page 73
Adaptors	page 74
Other Accessories	page 75
Accessories	page 76
Tools & Finishing Accessories	page 76

Anchoring Solutions

Concrete Wire Anchor

- Suitable for non-cracked concrete and hard natural stone
- Stainless steel (304/A2)
- CSTB test report

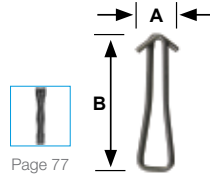

Page 77

3:1 Safety rating - load rating is dependant on base material

Product code	A (mm)	B (mm)	Max. SWL (kg)	Hole Ø (mm)	Min. Hole depth* (mm)	Min. Anchorage depth* (mm)	Quantity
GR1HK100P	15,3	50	45	8	30	30	100

* For further information contact Gripple Technical Services

Installation

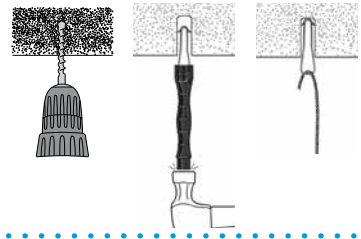

Drop-In Anchor

- Suitable for non-cracked concrete, precast hollow core concrete and hard natural stone
- Internal threaded anchor with flared end for easy setting

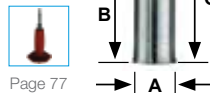

Page 77

3:1 Safety rating - load rating is dependant on base material

Product code	A	B (mm)	C (mm)	Max. SWL (kg)	Hole Ø (mm)	Min. Hole depth* (mm)	Anchorage depth* (mm)	Quantity
GR1PCHEV6	M6	13	25	140	8	27	25	10
GR1PCHEV8	M8	12	30	185	10	33	30	10
GR1PCHEV10	M10	15	40	290	12	43	40	10

* For further information contact Gripple Technical Services

Installation

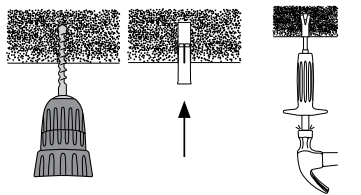

Concrete Screw

- Suitable for cracked and non cracked concrete
- Ideal for use with the 90° Eyelet End Fixing (page 63)
- Removable

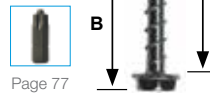

Page 77

1:1 Safety rating - load rating is dependant on base material

Product code	A (mm)	B (mm)	Max. SWL (kg)	Hole Ø (mm)	Min. Hole depth* (mm)	Min. Anchorage depth* (mm)	Quantity
GR1PBEO90	40	47	170	6	38	25	100

* For further information contact Gripple Technical Services

Installation

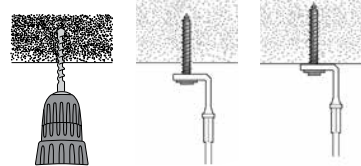

Barrel Concrete Screw

- Suitable for cracked and non-cracked concrete, precast hollow concrete and hard natural stone
- Easy-fit screw with integrated male thread connection
- Ideal for use with the M8 Barrel End Fixing (page 64)
- Removable

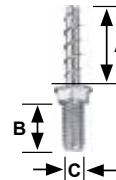

1:1 Safety rating - load rating is dependant on base material

Product code	A (mm)	B (mm)	C (mm)	Max. SWL (kg)	Hole Ø (mm)	Min. Hole depth* (mm)	Min. Anchorage depth* (mm)	Quantity
GR1PBET8	35	16	M8	170	6	38	25	100

* For further information contact Gripple Technical Services

Installation

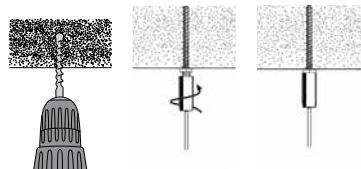

Stud Concrete Screw

- Suitable for cracked and non cracked concrete
- Dual M8/M10 internal thread
- Ideal for use with the Stud End Fixing (page 58)
- Removable

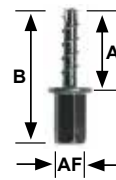

1:1 Safety rating - load rating is dependant on base material

Product code	A (mm)	B (mm)	AF (mm)	Max. SWL (kg)	Hole Ø (mm)	Min. Hole depth* (mm)	Min. Anchorage depth* (mm)	Quantity
GR1PVBFM8M10	35	60	13	170	6	38	25	100

* For further information contact Gripple Technical Services

Installation

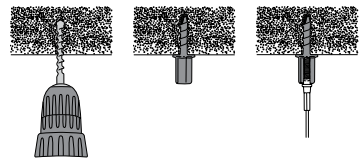

Concrete Ring Anchor

- Suitable for cracked and non cracked concrete
- Self-expanding anchor
- ETA approved

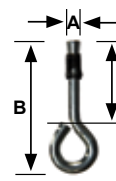

3:1 Safety rating - load rating is dependant on base material

Product code	A (mm)	B (mm)	C (mm)	Max. SWL (kg)	Hole Ø (mm)	Min. Hole depth* (mm)	Min. Anchorage depth* (mm)	Quantity
GR1POEILM6	6	54	31	57	6	35	25	100

* For further information contact Gripple Technical Services

Installation



M6 Spring Toggle

- Expands by spring force into any cavity
- Suitable for pre-stressed hollow core concrete / plasterboard and slabs made from perforated brick
- Ideal for use with the Snap hook end fixing (page 60)

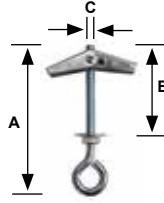

Installation

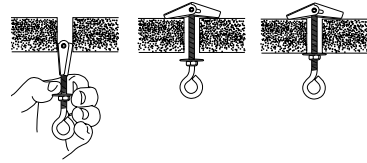

3:1 Safety rating - load rating is dependant on base material

Product code	A (mm)	B (mm)	C (mm)	Max. SWL (kg)	Hole Ø (mm)	Min. Hole depth* (mm)	Min. Anchorage depth* (mm)	Quantity
GRIPCREUX6	92	60	M6	15	18	45	35	10

* For further information contact Gripple Technical Services

Concrete Ceiling Anchor

- Suitable for non-cracked concrete and hard natural stone
- Knock into a pre-drilled hole and pull with a claw hammer to set
- Ideal for use with the HF Express (page 26)

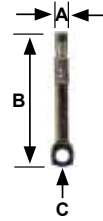

Installation

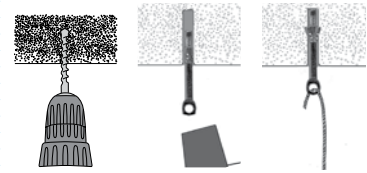

3:1 Safety rating - load rating is dependant on base material

Product code	A (mm)	B (mm)	C Ø (mm)	Max. SWL (kg)	Min. Hole depth* (mm)	Min. Anchorage depth* (mm)	Quantity
GRIPCHW6	6	60	6,2	45	43	25	100

* For further information contact Gripple Technical Services

Concrete Wood Screw

- Easy-fit screw suitable for wood, non-cracked concrete, precast hollow concrete and hard natural stone
- Ideal for use with the range of Eyelet End Fixings (page 62)
- Removable

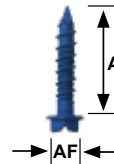

Installation

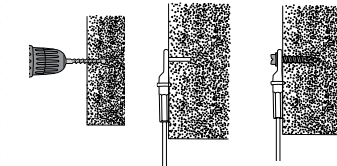

3:1 Safety rating - load rating is dependant on base material

Product code	A (mm)	AF (mm)	Max. SWL (kg)	Hole Ø (mm)	Min. Hole depth* (mm)	Min. Anchorage depth* (mm)	Quantity
GRIPVCBB	32	8	100	5	35	25	100

* For further information contact Gripple Technical Services

Concrete Wood Screw

- Easy-fit screw suitable for wood, non-cracked concrete, precast hollow concrete and hard natural stone
- Ideal for use with the range of Top Hat End Fixings (page 61)
- Removable

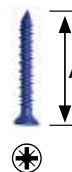

Installation

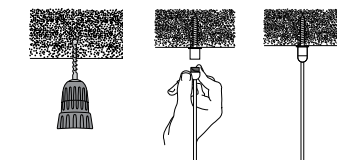

3:1 Safety rating - load rating is dependant on base material

Product code	A (mm)	Max. SWL (kg)	Hole Ø (mm)	Min. Hole depth* (mm)	Min. Anchorage depth* (mm)	Quantity
GRIPVCBBP2	32	100	4	35	25	100

* For further information contact Gripple Technical Services

Barrel Wood Screw

- Easy-fit wood screw with integrated M6 thread connection
- Ideal for use with the M6 Barrel End Fixing (page 64)

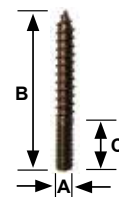

Installation

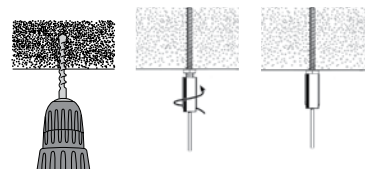

SWL - load rating is dependent on wood type

Product code	A	B (mm)	C (mm)	Max. SWL (kg)	Hole Ø (mm)	Hole depth* (mm)	Min. Anchorage depth* (mm)	Quantity
GRIPWSA	M6	50	15	N/A	4,5	40	35	100

* For further information contact Gripple Technical Services

Eyebolt

- Closed-eyes for ultimate strength
- Ideal for suspending services with HF Classic (page 27)
- Available fully threaded or partially threaded

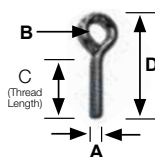

Installation

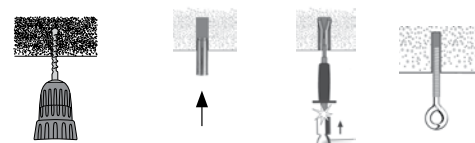

5:1 Safety rating

Product code	A	B (mm)	C (mm)	D (mm)	Max. SWL (kg)	Quantity
OEIL813	M8	13	130	168	325	10
OEIL820	M8	13	200	230	325	10
OEIL82F	M8	13	200	230	325	10

Product code	A	B (mm)	C (mm)	D (mm)	Max. SWL (kg)	Quantity
OEIL1013	M10	13	130	174	325	10
OEIL1020	M10	13	200	238	325	10
OEIL102F	M10	13	200	238	325	10

Beams & Purlins

Tiger Clip

- Hammer-on installation
- Accommodates a wide variety of flange thicknesses
- Ideal for use with the Hook End Fixing (page 60)

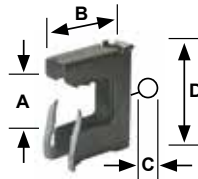

3:1 Safety rating

Product code	A (mm)	B (mm)	C (mm)	D (mm)	Max. SWL (kg)	Quantity
TIGERCLIP28	2-8	30	6,7	30	120	100
TIGERCLIP816	8-16	32	6,7	38	120	100

Vertical Flange Clip

- Hammer-on installation
- Two sizes available to suit 1 mm - 5 mm and 5 mm - 7 mm flange thickness
- Ideal for use with the Hook End Fixing (page 60)

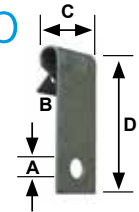

3:1 Safety rating

Product code	A (mm)	B (mm)	C (mm)	D (mm)	Max. SWL (kg)	Quantity
GCVF15	6,5	1-5	19	39	72	100
GCVF57	6,5	5-7	19	40	72	100

Purlin Clip

- Easy installation - clip into place
- Available to suit 4 mm - 5 mm flange thickness
- Ideal for use with the Hook End Fixing (page 60)

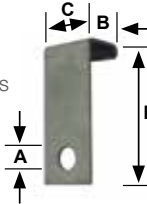

3:1 Safety rating

Product code	A (mm)	B (mm)	C (mm)	D (mm)	Max. SWL (kg)	Quantity
GCP45	6,5	15	19	45	20	100

Z Purlin Clip

- Hammer-on installation
- Available to suit 2.5 mm maximum flange thickness
- Ideal for use with the Hook End Fixing (page 60)

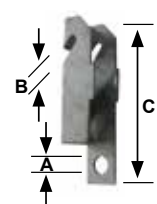

3:1 Safety rating

Product code	A (mm)	B (mm)	C (mm)	Max. SWL (kg)	Quantity
GCZP48	6,5	2,5	48	72	100

Beam Clip

- Hammer-on installation
- Accommodates a wide variety of flange thicknesses
- Ideal for use with the Hook End Fixing (page 60)

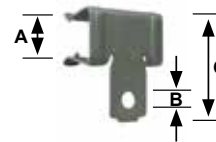

3:1 Safety rating

Product code	A (mm)	B (mm)	C (mm)	Max. SWL (kg)	Quantity
GCB24	2-4	6,5	21	72	100
GCB59	5-9	6,5	23	90	100
GCB1016	10-16	6,5	29	90	100
GCB1720	17-20	6,5	34	90	100

Installation

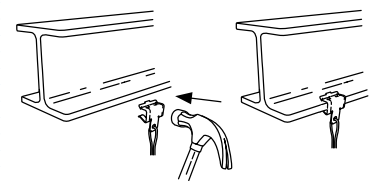

GF Bracket

- Designed for clamping onto an I-Beam section
- Suitable from 6 mm - 19 mm thicknesses
- Use with M12 threaded rod (not supplied)
- Ideal for use with Catenary Kits (page 42)

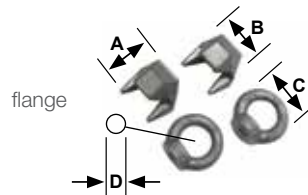

5:1 Safety rating

Product code	Beam Flange Thickness (mm)	A (mm)	B (mm)	C (mm)	D (mm)	Max. SWL (kg)	Quantity
GRIPPROFIL613	6-13	46	47	55	30	340	1
GRIPPROFIL816	8-16	62	62	55	30	340	1
GRIPPROFIL1019	10-19	75	75	55	30	340	1

Installation

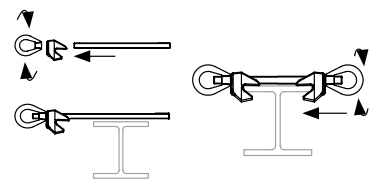

Catenary Wall Bracket

- 100 mm x 100 mm back plate for concrete walls and wooden beams
- 4 x 11 mm diameter mounting holes
- 65 mm hole spacing
- 9 mm ring for easy wire rope attachment
- Zinc plated finish (minimum 5 µm)



3:1 Safety rating

Product code	A (mm)	B (mm)	C (mm)	D (mm)	Max. SWL (kg)	Quantity
PLAT100	100	45	65	11	340	1

Installation

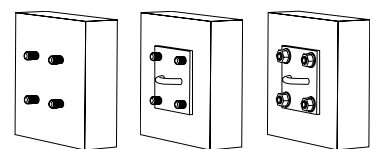

C-Clip Accessory

- Twist-on device for hanging at any point on a EP Kit
- Install up to 10 times faster than traditional methods
- C-Clip accessory is ideal for attaching a decoration, when no vertical adjustment is required

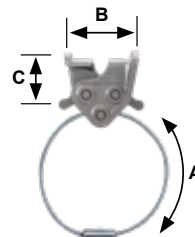

5:1 Safety rating

Product code	A (mm)	B (mm)	C (mm)	Max. SWL (kg)	Quantity
ACCEP6	200	45	45	45	10

Installation



Brackets & Attachments

G-Bracket

- Purpose made for cable tray and basket
- Brackets can be easily joined together either vertically or horizontally to create a double fixing
- Ideal for use with the Y-Fit and Y-Fit Accessory (page 40)

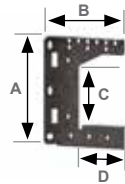

3:1 Safety rating

Product code	A (mm)	B (mm)	C (mm)	D (mm)	Max. SWL (kg)	Quantity
G100	200	188	110	125	60	1
G200	200	263	110	200	60	1
G300	202	389	110	325	60	1
G400	202	489	100	425	60	1

Installation

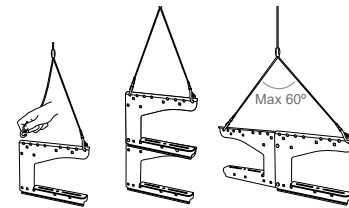

G-Spacer

- Joins two G-Brackets together, either vertically or horizontally allowing a central gap (max. 300 mm)
- Links different sizes of G-Bracket together
- Adjustable

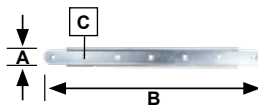

5:1 Safety rating

Product code	A (mm)	B (mm)	C (mm)	Quantity
GSPACER	26	325	7x7	10

Installation

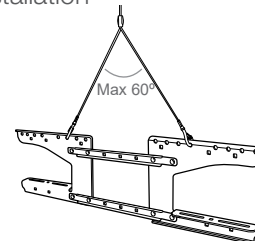

CB Clip

- Secure – Prevents uplift and slide of cable basket
- Versatile – Two sizes available to fit 4 mm and 5 mm cable basket wire
- Easy – tool-free, quarter turn installation

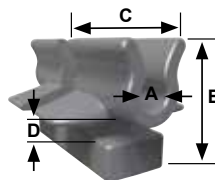

Product code	A Ø (mm)	B (mm)	C (mm)	D (mm)	Quantity
CBC4100P	4	17	30	2	500
CBC5100P	5	17	30	2	500
CBC43100P	5	17	30	3	500
CBC53100P	5	17	30	3	500

Installation

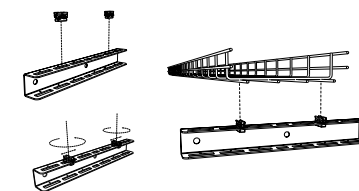

CT Clip

- Secure – Prevents uplift and slide of cable tray
- Versatile – Two sizes available to fit 2 mm and 3 mm thick steel
- Easy – tool-free, quarter turn installation
- Quick – push fit fixing saves time on the install, when compared to traditional methods

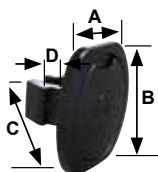

Product code	A (mm)	B (mm)	C (mm)	D (mm)	Quantity
CTC2100P	22	19	13	2	500
CTC3100P	22	19	13	3	500

Installation

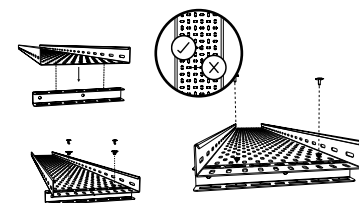

Link Hook

- Easy to attach and detach for loading cable tray
- Suitable for services that require access or maintenance
- Large inner dimension for easy fit
- Ideal for use with the Y-Fit and Y-Fit Accessory (page 40)

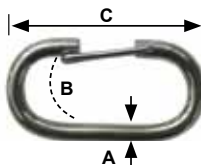

4:1 Safety rating

Product code	A (mm)	B (mm)	C (mm)	Max. SWL (kg)	Quantity
LINKHOOK	6	15	48	45	10

Installation

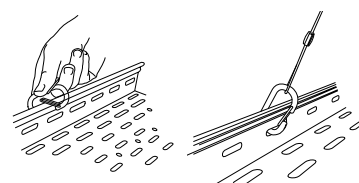

Karabiner

- Versatile fixing, easy to attach and detach
- Available in Stainless steel ("I" endings in the code below)

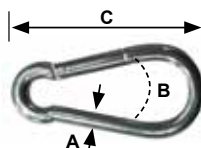

5:1 Safety rating

Product code	A (mm)	B (mm)	C (mm)	Max. SWL (kg)	Quantity
GRIPKARA6	6	8	60	45	10
GRIPKARA6I	6	8	60	45	10
GRIPKARA8	8	10	80	90	10
GRIPKARA8I	8	10	80	90	10

Installation

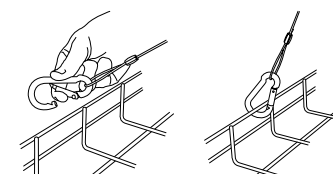

Adaptors

M6 & M8 Adaptor

- Ideal for fixings to many services such as luminaires
- Can be fixed into concrete using the Drop-In Anchors (page 70)
- Supplied with nut

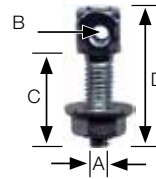

5:1 Safety rating - dependent on material

Product code	A	B (mm)	C (mm)	D (mm)	Max. SWL (kg)	Quantity
GRIPADAP6	M6	3,5	20	28	90	10
GRIPADAP8	M8	5,5	25	37	225	10

Installation

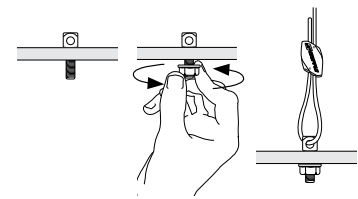

Spring Clip

- Used for attaching to services such as trunking and lighting
- For 6 mm - 8 mm holes
- Ideal for use with the HF Express (page 26)

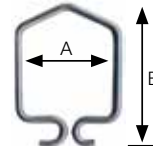

3:1 Safety rating - dependent on material thickness

Product code	A (mm)	B (mm)	Max. SWL (kg)	Quantity
SPRINGCLIP	24	38	30	100

Installation

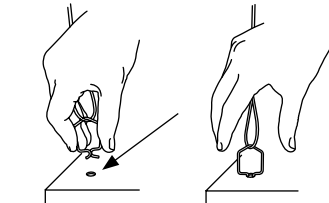

Pigtail

- Fast and secure anchor suitable for use with the Loop End Fixing (page 58)
- Ideal for use with the Drop-In Anchor (page 70)
- Allows Loop to be removed for maintenance

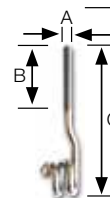

5:1 Safety rating - dependent on base material

Product code	A	B (mm)	C (mm)	Max. SWL (kg)	Quantity
GRIPM620	M6	20	76	90	10
GRIPM645	M6	45	102	90	10
GRIPM845	M8	45	118	150	10

Installation

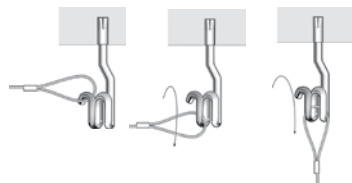

Turnbuckle

- Ideal for cold room panels
- One end with closed-eye/one end with straight threaded rod
- Use with the HF Classic (page 27)

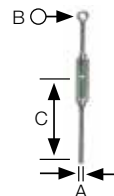

5:1 Safety rating - dependent on material

Product code	A	B (mm)	C (mm)	Max. SWL (kg)	Quantity
OEL88TD	M8	14	80	325	10
OEL820TD	M8	14	200	325	10
OEL1020TD	M10	14	200	325	10

Installation

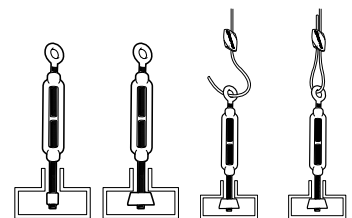

T-Bar Twist Clip

- Ideal for attaching to suspended ceilings
- Integral M6 x 16 mm thread
- Ideal for use with the Barrel End Fixing (page 64)
- Suitable for 24 mm T-Bar grid ceilings

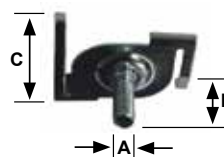

5:1 Safety rating

Product code	A	B (mm)	C (mm)	Max. SWL (kg)	Quantity
TWISTCLIP	M6	16	25	22	10

Installation

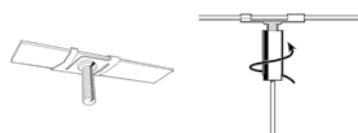

T-Bar Twist Clip

- Ideal for hanging from suspended ceiling T-Bar, signage, acoustic baffles or luminaires
- Integral M6 x 11 mm thread
- Ideal for use with the Top Hat End Fixing (page 61)
- Suitable for 24 mm T-Bar grid ceilings

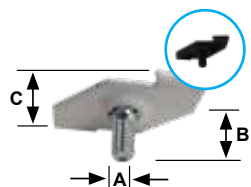

5:1 Safety rating

Product code	A	B (mm)	C (mm)	Max. SWL (kg)	Quantity
TWISTCLIPW	M6	11	25	22	10
TWISTCLIPB	M6	11	25	22	10

Installation

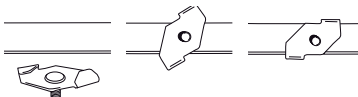

Other Accessories

Spreader Band

- Snap to length as required, live hinges allow for flexibility of use
- Easily installed to wire using integrated clips
- Wire is retained in clip with security latch
- Ideal for use with insulation, fabric duct and bundled cable

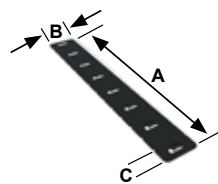

5:1 Safety rating - dependent on material

Product code	A (mm)	B (mm)	C (mm)	Max. SWL (kg)	Quantity
GRIPSPB	300	40	20	90	25

Installation

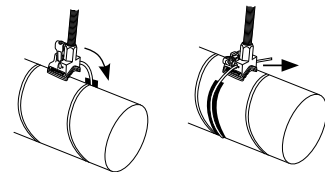

Wall Bracket

- Allows to connect the PB Kit to any supporting material
- Made of steel with electrogalvanized finish
- Available in 3 sizes

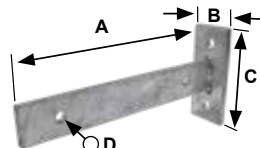

5:1 Safety rating - dependent on material thickness

Product code	A (mm)	B (mm)	C (mm)	D (mm)	Max. SWL (kg)	Quantity
GRIPWB24	246	50	120	12,5	75	1
GRIPWB34	346	50	120	12,5	75	1
GRIPWB44	446	50	120	12,5	75	1

Installation

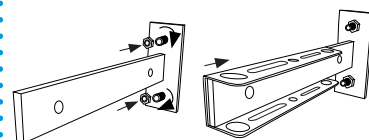

Bracket Beam Clamp

- Allows brackets to be fixed directly to beams for pipe runs close to the deck
- Suitable for a wide range of flange sizes (up to 40 mm)
- Robust, mild steel construction
- Kit of 2 pieces

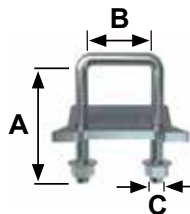

Product code	A (mm)	B (mm)	C (mm)	Max. SWL (kg)	Quantity
GRIPBC	83	45	M10	150	1

Installation

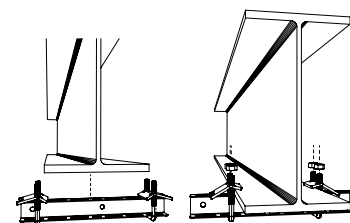

CRU QT

- Up to 6 times faster than traditional methods
- Universal - for pipe sizes 15 mm Copper (OD15) to 3" / DN80 Steel (OD89) pipework
- Replaces more than 11 different pipe ring sizes
- ¼ turn fixing - tool free attachment and adjustment

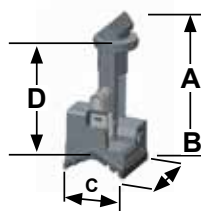

5:1 Safety rating - dependent on base material

Product code	A (mm)	B (mm)	C (mm)	D (mm)	Max. SWL (kg)	Quantity
GC2T400AP	68,5	29,4	29,9	52,1	75	100

Installation

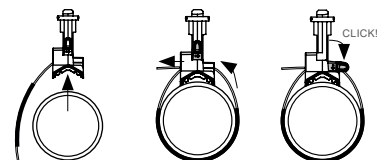

CRU QTC

- Up to 6 times faster than traditional methods
- Universal - for pipe sizes 15 mm Copper (OD15) to 3" / DN80 Steel (OD89) pipework
- Replaces more than 11 different pipe ring sizes
- ¼ turn fixing - tool free attachment and adjustment

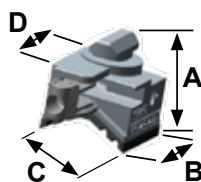

5:1 Safety rating - dependent on material

Product code	A (mm)	B (mm)	C (mm)	D (mm)	Max. SWL (kg)	Quantity
GC2C400AP	32,6	29,4	29,9	56,1	75	100

Installation

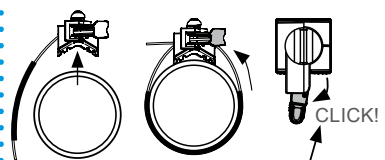

Acoustic Spring Anchor

- Ideal for use with the Angel Hook
- Available in standard (40 mm) and large size (70 mm) with 2 mm wire diameter
- Maximum load ratings will vary. Contact Gripple Technical Services for more information
- Must be tested before use with the manufacturer's baffle

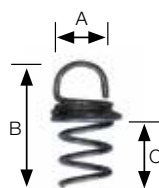

Product code	A (mm)	B (mm)	C (mm)	Kit Quantity
RBACRT12	17	47	28	12
RBALNG12	27	97	72	12

Installation

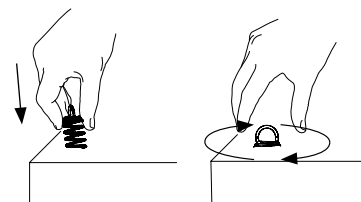

Accessories

UniGrip – Standard

Designed for non-mechanical fixing through brackets
Supplied with retention clip for pre-fabrication applications.
Load rating of 55-110 kg with a 5:1 safety factor

Product code:
UG2ACC
UG3ACC



UniGrip – Central Exit

Designed for services suspended with channel for multi-tiered installations. Load rating of 55-250 kg with a 5:1 safety factor.

Product code:
UG2RACC
UG3RACC
UG4RACC



UniGrip – QT

Ideal for use with PB and LPB Kits to suspend pipework.
Quarter turn installation, no mechanical fix required.
Maximum load rating of 110 kg with a 5:1 safety factor.

Product code:
UGT2ACC
UGT3ACC



Trapeze TPZPL

Ideal for use with light ductwork. Combine Trapeze TPZPL as an accessory with any Trapeze kit for multi-tiered installations. Maximum load rating of 45 kg with a 5:1 safety factor.

Product code:
GRIPTRAPPL2I



Trapeze TPZGR

Ideal for use with rectangular ductwork. Combine Trapeze TPZGR as an accessory with any Trapeze kit for multi-tiered installations. Maximum load rating of 45 kg with a 5:1 safety factor.

Product code:
GRIPTRAPGR2I



Tools & Finishing Accessories

Tensioning Tool

- Applies tension easily with the 6:1 gear drive mechanism
- Designed control mechanism to prevent over tensioning
- Compact, easy to handle, operate and carry
- For use with 6 mm CTI and EP kits

Product code:
GRIPTORQCTID



Adjustment Keys

- Use for adjusting the HF Classic height (pre-load)
- Two sizes available – for HF Classic No.1 to No.3, CTI and EP kits
HF Classic No.4 and No.5

Product code:
GRIPCLE1
(for sizes No.1 - No.3, CTI and EP kits)
GRIPCLE2
(for sizes No.4, No.5)



Tools & Finishing Accessories

Drop-In Anchor Punch

- Leaves four permanent indents on the anchor to advise correct installation
- Ergonomic handle with hand protection
- Three sizes available to suit M6, M8 or M10 anchor

Product code:
GRIPICH6
GRIPICH8
GRIPICH10



Protective Sleeving

- Protective black tubing
- Ideal for use on 2 mm and 3 mm wire rope
- Available in 25 m lengths as standard

Product code:
GRIPPVC2
GRIPPVC3



Driver Bit

- For use with a power driver
- Torx head to fit Concrete Screw or Cracked Concrete Screw (page 70)

Product code:
OUTVBET



Wire Anchor Installation Tool

- Tool securely locates onto the wire anchor to hammer into place

Product code:
GRIPTIHK



Fixing Tool for Ceiling Clip Wood

- For use with a power driver
- Hexagonal head to fit AF 8 mm

Product code:
OUTLVAB



Wire Cutters

- Hardened, durable jaws
- Two sizes available – pocket size for use up to 3 mm diameter wire rope

Product code:
GRIPPINC



Ceiling Fixing Kit

- Decorative cover to sit flush against a suspended ceiling
- Hides the HF Classic Hanger
- Suitable for No.1 wire size

Product code:
GRIPDECO



Wire Cutters

- Hardened, durable jaws
- Two sizes available – size for use up to 6 mm diameter wire rope

Product code:
GRIPPINC6



Corner Saddle

- Ideal for use with phenolic ductwork
- Also available with magnetic fixing for steel
- Use with wire rope up to 3 mm

Product code:
GRIPCISO (standard)
GRIPCISOM (magnetic)



Twister

- Keeps tail wires neat and tidy
- Grey aesthetic finish - blends into background
- For use with 2 mm and 3 mm wire rope

Product code:
GRIPTWIST



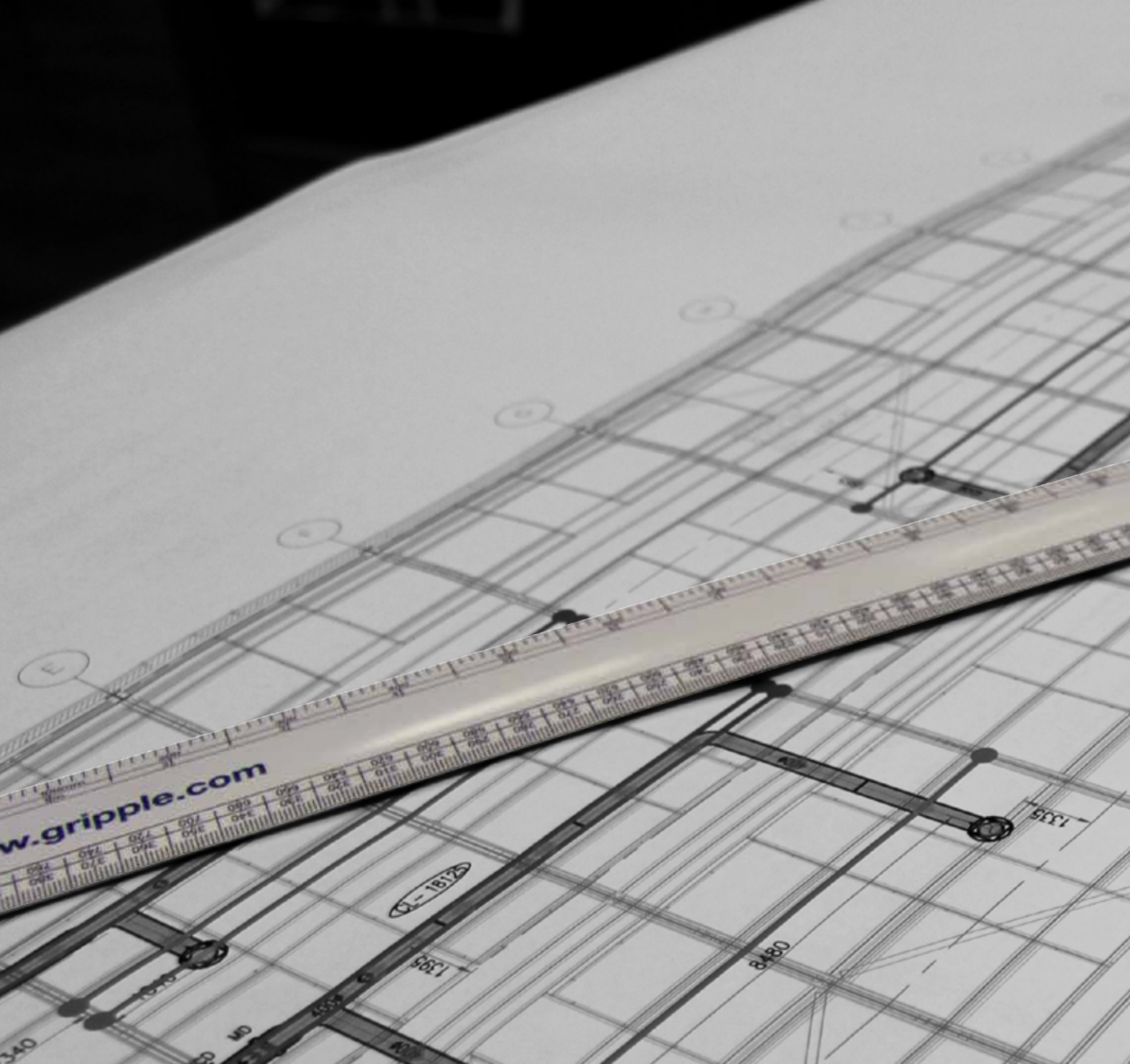

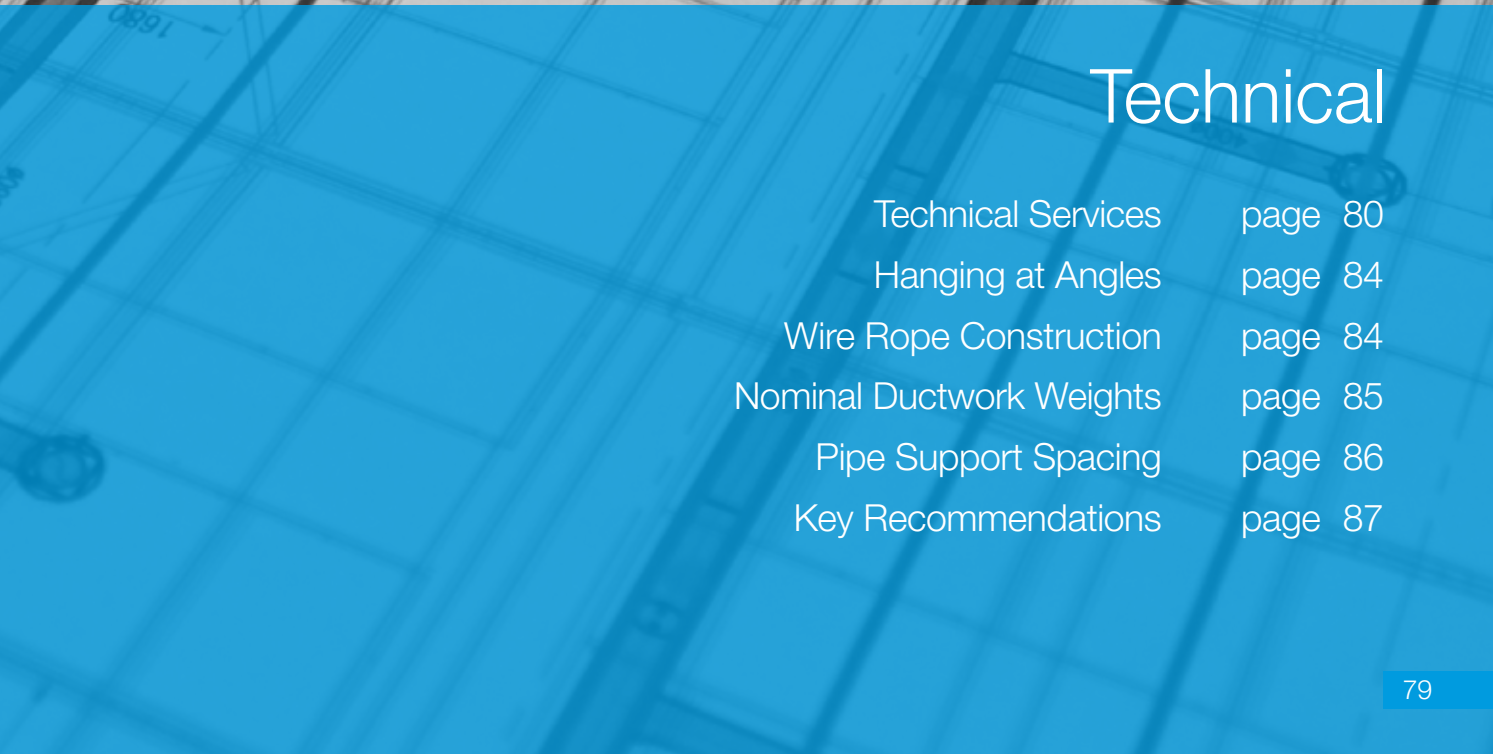

Technical

Technical Services	page 80
Hanging at Angles	page 84
Wire Rope Construction	page 84
Nominal Ductwork Weights	page 85
Pipe Support Spacing	page 86
Key Recommendations	page 87

Technical Services



Gripple Technical Services is able to provide you with continuous skilled technical support. For information about this service, please contact your Gripple sales representative; or contact the Gripple Europe office in Obernai on +33 (0)3 88 95 44 95 – planservice@gripple.com

Installation Design

Gripple Technical Services offers a full suspension system design service. Drawings can be submitted in either .dwg or .pdf file formats and are returned fully annotated and costed. Bespoke bracket design, and assistance with minimising suspension elements and cost can also be provided. In order to reduce programme time and installation costs further, Gripple Catenary Systems can be employed to span structural steels and suitable building components. Gripple's Installation Design service provides the contractor with annotated drawings showing the location and length of each catenary wire to simplify the installation process.

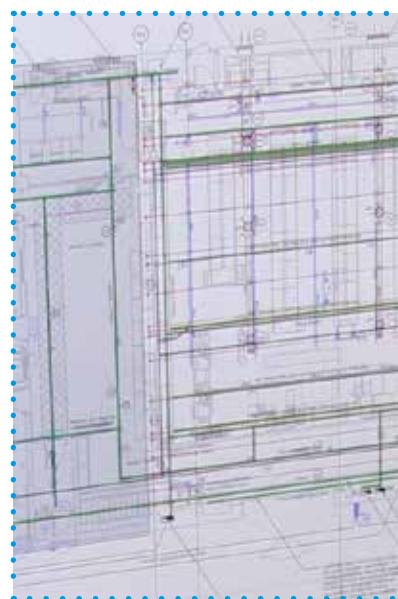

Catenary Tension Analysis

Catenary systems can impose loads on building structures far in excess of the vertical loads applied to each free span. It's for this reason that Gripple Technical Services offers computer modelled catenary tension analyses to determine both final catenary sag and more importantly, anchor point loading. This ensures that all catenary systems installed meet the requirements of the structural engineer.

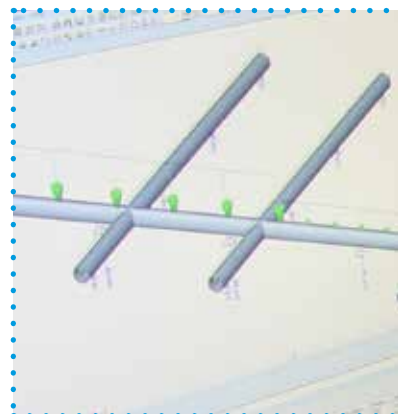

BIM

Building Information Modelling (BIM) is now a mandatory requirement for centrally funded government projects in Europe, and this highly collaborative way of working is fast becoming the preferred method for carrying out progressive private sector projects.

Gripple is the only supplier of wire rope suspension systems that offers consultants and contractors full BIM support in the form of 3D model families. This allows designers to add both fixed and suspended supports for building services, and carry out clash detection in the virtual project environment.

Models are available in a range of file formats including .rfa, .ifc and .dwg and offer full connectivity to product data which can be used to aid cost management, construction collaboration and facilities management.

Detailed schedules of Gripple components can be created meaning only the correct quantity of product is ordered, minimising cost and waste. Gripple Technical Services has recognised the advantages that BIM brings to construction projects and is committed to working with consultants and contractors to develop their BIM capabilities.

Contact Gripple Technical Services for the latest BIM models.

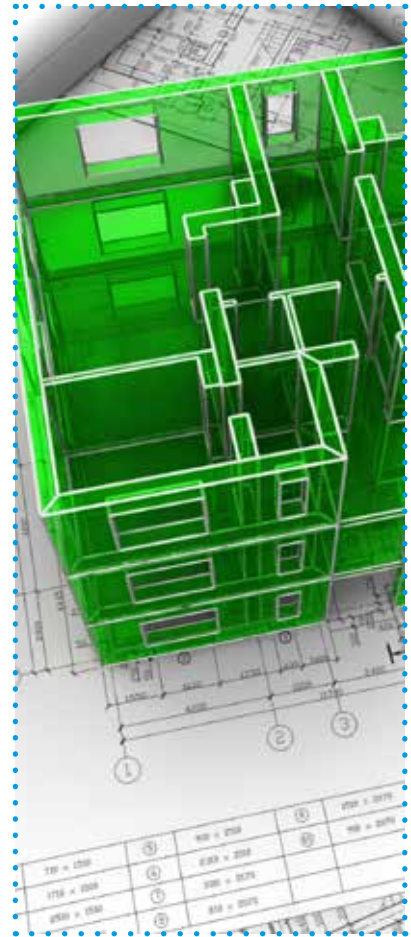

Embodied CO₂ Assessment and BREEAM or LEED Accreditation

Gripple recognises that today's buildings need to be designed to the highest environmental standards. In order to facilitate this, Gripple Technical Services is able to provide calculations, based on drawing submissions or site surveys, to determine the ECO₂ savings when switching to lightweight wire rope suspension systems. This supporting evidence can then be submitted to BREEAM assessors in order to obtain BREEAM credits or to LEED assessors for LEED points.



Seismic Bracing & Blast Protection Systems

Gripple is a leading provider of seismic bracing and blast protection systems.

In contrast to standard wire bracing, Gripple's seismic system is fully tested and approved to OSHPD OPA-2123-10 and has SMACNA verification, recognised as the most demanding requirement in the world.



Gripple Technical Services can offer:

1. Engineered seismic bracing calculations based on design category, occupancy, importance and relevant site specific seismic specifications.
2. Detailed engineer's sealed drawings (electronic format) prepared in AutoCAD or PDF files (submitted by the consultant/contractor) indicating the location of seismic bracing points and bracket type.
3. Gripple on-site training on seismic product installation.
4. Completion visit by Gripple Seismic Authorized Representative to ensure correct installation.
5. Gripple Seismic Bracing products per engineering calculations, including:
 - a. Seismic wire rope kit with End Fixing and colour coded verification tag
 - b. Seismic component bracket
 - c. Gripple Seismic Hanger



Acoustic & Vibration Performance

Gripple wire suspensions offer vastly improved acoustic performance over traditional installation methods. Gripple Technical Services can supply independent test data which confirms the levels of attenuation that Gripple wire rope suspensions achieve over a range of audible and inaudible frequencies, when compared to threaded rod.



Technical Specifications & Best Practice Guides

Gripple Technical Services offers a range of published material to ensure that installations are done in accordance with the best standards. Titles include 'A Guide to the use of Wire Suspensions in Swimming Pool Environments', 'Suspension of Ductwork and Associated Services with Steel Wire Ropes' and 'Suspension of Pipework and Associated Equipment with Steel Wire Ropes'. A generic specification is also available should you wish to include wire rope suspension systems in your design without specifying Gripple products. Gripple Technical Services can also offer advice should Fire Rated Suspension Systems be required.

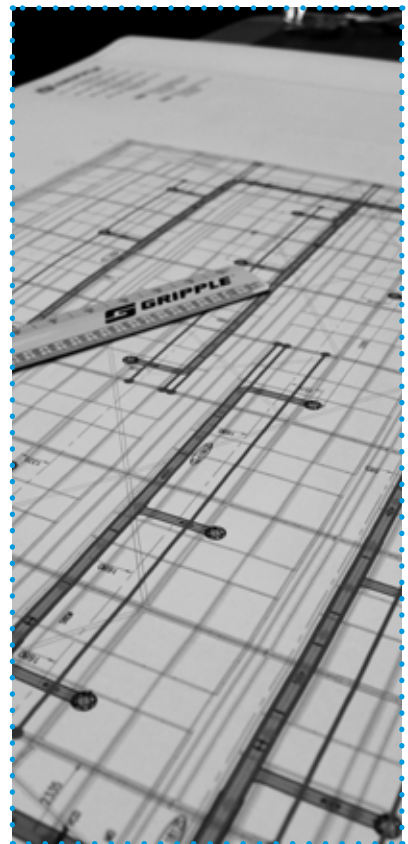

On-site Support

Pre-commencement site surveys, on-site pull testing to verify substrate suitability, progress reports and completion certificates can all be requested from Gripple Technical Services. Toolbox Talks are also available on a range of Gripple products and time saving installation methods.



Hanging at Angles

The load rating for a Gripple Hanger is based on the suspension being hung vertically. If the wire rope is at an angle, an additional sideways force is applied which increases the load on the suspension. The net effect is shown in the table below.

Hanger size	Maximum load (kg) at an angle from vertical				
	0°	15°	30°	45°	60°
No.1	15	14	12	10	7
No.2	45	43	39	32	22
No.3	90	87	78	64	45
No.4	225	217	195	159	113
No.5	325	314	281	230	163
Load %	100	96	86	70	50

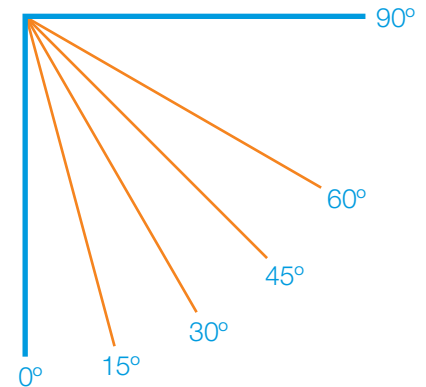

For Gripple hanger hung at an angle in excess of 60° from vertical, contact Gripple Technical Services.

Wire Rope Construction

The wire ropes used within our product ranges are manufactured with a galvanised coating in accordance with the norm EN 12385.

Wire rope size	Diameter (mm)	Construction
No.1	1,5	7 x 7 or 1 x 19
No.2	2	7 x 7 or 1 x 19
No.3	3	7 x 7 or 1 x 19
No.4	4,75	7 x 19
No.5	6	7 x 19

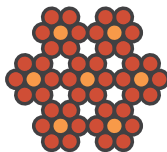

7 x 7 (6/1)

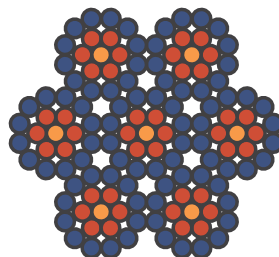

7 x 19 (12/6/1)

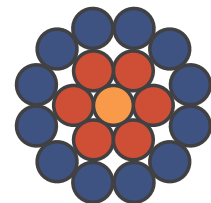

1 x 19 (12/6/1)

Nominal Ductwork Weights

Galvanised Steel Spirally Wound Circular Ductwork

The Gripple hanger size is based on a 2,5 m hanger spacing.

Diameter (mm)	Circumference (m)	Weight (kg/m)	Min. Gripple Hanger size
80	0,25	1,00	No.1
100	0,32	1,56	No.1
125	0,40	1,96	No.1
160	0,50	2,50	No.1
200	0,63	3,75	No.2
250	0,80	4,69	No.2
300	0,94	5,63	No.2
315	1,00	5,92	No.2
400	1,26	9,10	No.2
500	1,57	11,50	No.2
630	1,98	14,50	No.2
710	2,23	16,15	No.3
1000	3,14	28,50	No.3
1250	3,93	45,30	No.4

This table is an extract from DW/144 2013 edition.

Rectangular Ducting

Size (mm)	250	500	750	1000	1250	1500	1750	2000	2250	2500	2750	3000
250	7,25	10,75	14,25	19,00	-	-	-	-	-	-	-	-
500	-	14,25	17,75	22,75	34,00	38,75	47,75	52,75	-	-	-	-
750	-	-	21,25	26,25	38,75	43,50	52,75	58,00	68,50	74,00	90,75	97,00
1000	-	-	-	30,00	43,50	48,25	58,00	63,00	74,00	79,50	97,00	103,50
1250	-	-	-	-	48,25	53,00	63,00	68,00	79,50	85,00	103,50	109,75
1500	-	-	-	-	-	57,75	68,00	73,25	85,00	90,50	109,75	116,00
1750	-	-	-	-	-	-	73,25	78,25	90,50	96,00	116,00	122,25
2000	-	-	-	-	-	-	-	83,50	96,00	101,50	122,25	128,50
2250	-	-	-	-	-	-	-	-	101,50	107,00	128,50	134,75
2500	-	-	-	-	-	-	-	-	-	112,50	134,75	141,00
2750	-	-	-	-	-	-	-	-	-	-	141,00	147,50
3000	-	-	-	-	-	-	-	-	-	-	-	153,75

For galvanised steel spirally-wound flat oval ductwork, insulated ductwork and phenolic ductwork weights, please contact Gripple Technical Services.

Pipe Support Spacing

Recommended maximum support spacing for steel and copper pipes.

Copper Pipes

Copper tube	Nominal pipe size	OD	Weight empty	Weight filled	Max. spacing for horizontal runs	Weight per Gripple Clamp*
BS EN 1057 (Table X)	mm	mm	kg/m	kg/m	m	kg
	15	15	0,28	0,43	1,2	0,51
	22	22	0,53	0,85	1,8	1,53
	28	28	0,68	1,22	1,8	2,19
	35	35	1,13	1,96	2,4	4,72
	42	42	1,37	2,60	2,4	6,24
	54	54	1,77	3,86	2,7	10,43
	67	67	2,74	5,96	3,0	17,87
	76	76	3,12	7,31	3,0	21,92

Mass calculated at standard pressure with water at 4°C.

*At max. bracket spacing

Steel Pipes

Steel pipe	Nominal pipe size	OD	Weight empty	Weight filled	Max. spacing for horizontal runs	Weight per Gripple Clamp*
BS 1387 EN 10255	inches	mm	kg/m	kg/m	m	kg
	1/2	21	1,22	1,39	2,0	2,77
	3/4	27	1,58	1,91	2,4	4,59
	1	34	2,44	2,97	2,7	8,02
	1 1/4	42	3,14	4,05	2,7	10,93
	1 1/2	48	3,61	4,87	3,0	14,60
	2	60	5,10	7,14	3,4	24,29
	2 1/2	76	6,51	10,04	3,7	37,13
	3	89	8,47	13,37	3,2	42,79

Mass calculated at standard pressure with water at 4°C.

*At max. bracket spacing

Key Recommendations

Failure to comply with these recommendations may result in product malfunction and possible damage to property or person and will invalidate the Gripple guarantee. Gripple products are guaranteed to be free from defects in materials and workmanship in accordance with our terms and conditions. No other warranty, whether express or implied, including any warranty of merchantability or fitness for purpose shall exist in connection with the sale or use of any Gripple product.

Full technical information and installation instructions should be obtained directly from Gripple Limited, Gripple Europe or Gripple Inc., any regional Gripple office, or via the website www.gripple.com.

Please adhere to the following key recommendations:



Loads

Always operate the product within its stated safe working load range.



Lifting

Do not use for lifting, either by crane or as part of a pulley system. Suspend static loads only.



Installation

Do not walk or stand on the Gripple product installation unless expressly designed for this purpose.



Painting

Do not paint the hanger prior to installation. Ensure that the hanger is in its final position prior to applying any paint to the wire rope assembly. Do not move the fastener after painting.



Lubrication

Do not apply oil or any other lubricant to the hanger or any other part of the assembly.



Joining

Never join two ends together in-line.



Wire Rope

Always use the fastener supplied and specified wire rope. Never use on coated wire rope or other rope. Trim any damaged filaments with the wire cutter before use.



Environment

Do not use in chlorinated or chemically corrosive atmospheres. Galvanised hangers are for use in dry and air conditioned environments only. Stainless steel hangers should be considered for high to saturated humid environments after validation by a competent person. Not suitable for Swimming pools.



Impact

If there is potential for impact on the wire rope suspension or suspended services, seek advice from Gripple Technical Services prior to installation.



Hanging at an Angle to Vertical

Ensure that the load calculation considers the effect of 'side load'. For example, at an angle of 60° to vertical the SWL is effectively reduced by 50%.



Ducting: When installing included angle teardrop hangers on round/spiral ducting or pipes, the final included angle of the assembly should not exceed 60°.



Y-Fit: Legs on Y-Fit not to be installed greater than 60°.

Quality & Approval

Gripple Limited is ISO 9001:2008 and ISO 14001 certified. Gripple products meet the highest standards of quality with lowest environmental impact.



Gripple's policy is one of continuous development and innovation. We therefore reserve the right to alter specifications, etc. without notice.

www.gripple.com

info@gripple.com

Gripple Ltd (Headquarters)

The Old West Gun Works
Savile Street East
Sheffield S4 7UQ
UK

T | +44 (0)114 275 2255

F | +44 (0)114 275 1155

E | info@gripple.com

Gripple Europe SARL

1, rue du Commerce
BP 37
67211 Obernai Cedex
France

T | +33 (0)3 88 95 44 95

F | +33 (0)3 88 95 08 78

E | frinfo@gripple.com

Gripple Inc

1611 Emily Lane
Aurora
IL 60502
USA

T | +1 866 474 7753

F | +1 800 654 0689

E | usinfo@gripple.com

Gripple Benelux

1, rue du commerce
BP37
67211 Obernai Cedex
Frankrijk

T | +31 (0)70 363 34 30

F | +31 (0)70 362 18 44

E | bninfo@gripple.com

Gripple Portugal

Estrada Nacional 4
Km 46,5 Pontal
2985-201 Pegões
Portugal

T | +351 265 898 900

F | +351 265 898 879

E | ptinfo@gripple.com

Gripple GmbH

Pariser Ring 1
76532 Baden-Baden
Deutschland

T | +49 (0)700 95 44 95 11

F | +49 (0)700 95 08 78 11

E | deinfo@gripple.com

Gripple s.r.l

Via Ponte Pietra, 2
24123 Bergamo BG
Italia

T | +39 (0)35 300 246

F | +39 (0)35 424 0036

E | itinfo@gripple.com

Gripple Industrial Ibérica, S.L.

Ctra. Logroño km 7, 3 Pol. Europa 1
50011 Zaragoza
España

T | +34 97 678 32 67

F | +34 97 678 32 68

E | esinfo@gripple.com

Gripple Sp. z o.o.

Ul. Majerankowa 12A
04-889 Warszawa
Polska

T | +48 (0)22 635 62 08

F | +48 (0)22 188 12 58

E | plinfo@gripple.com

WE ARE SOCIAL
FOLLOW OUR UPDATES



For details please visit www.gripple.com or call our
Technical Team on +33 (0)3 88 95 44 95

